  
**MILEO**

CREATED FOR ADVENTURE



WATCH VIDEOS



VIRTUAL TOURS



PRESS REVIEWS



OVERVIEW

MILEO RANGE

FEATURES

WEIGHTS & DIMENSIONS

MILEO GALLERY

CONSTRUCTION

ABOUT BENIMAR

DEALER NETWORK





01. OVERVIEW

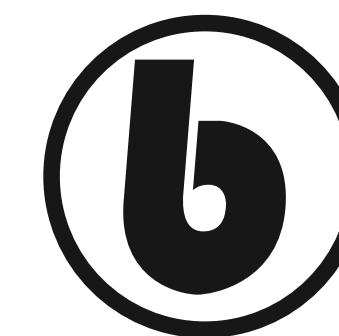

Life is indeed an adventure, and the right vehicle can make all the difference! The Mileo Range of motorhomes is designed for those who seek both comfort and the thrill of exploration.

With innovative features like low-profile designs and space-saving electric drop-down beds, these motorhomes are perfect for maximizing your travel experience.

With four models to choose from, there's a Mileo to match every lifestyle and adventure. Whether you're planning a cross-country journey or a weekend getaway, you'll find that your Mileo is equipped to make your travels smooth and enjoyable.

Embrace the freedom to explore—your next adventure awaits!

[VIEW OUR NATIONWIDE STOCK](#)

- WATCH VIDEOS
- 360° VIRTUAL TOURS
- PRESS REVIEWS



OVERVIEW

MILEO RANGE

FEATURES

WEIGHTS & DIMENSIONS

MILEO GALLERY

CONSTRUCTION

ABOUT BENIMAR

DEALER NETWORK





## 02. MILEO RANGE

# FIAT

The Benimar Mileo range is available on a manual 140bhp engine with a 3650kg chassis or a 180bhp automatic engine with a 4400kg chassis offering an exceptional payload for all your essentials.



TRACKSTAR

Your new Mileo motorhome is protected 24/7 with the Trafficmaster Trackstar S7 Tracker with One Years Subscription included.



GRP and 99% Wood-Free Construction. Benimar motorhomes offer the almost complete elimination of wood in the bodywork structure. The use of damp-proof materials, which are effective at insulating, guarantee the vehicle lasts longer



WATCH VIDEOS



VIRTUAL TOURS



PRESS REVIEWS



OVERVIEW

MILEO RANGE

FEATURES

WEIGHTS & DIMENSIONS

MILEO GALLERY

CONSTRUCTION

ABOUT BENIMAR

DEALER NETWORK



### MILEO 243

- 4 BELTS
- 4 BERTHS
- ISOFIX

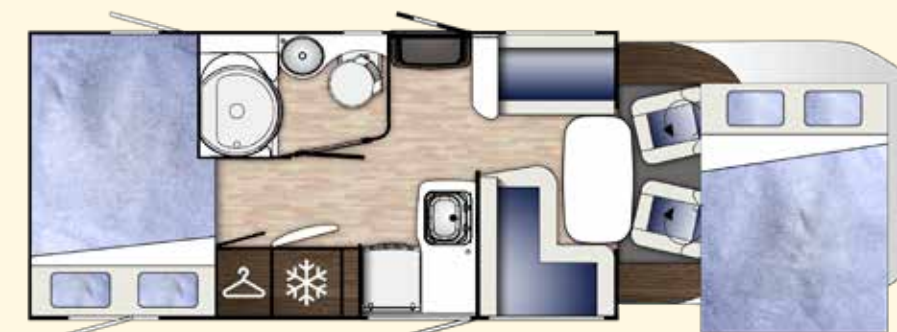

OVERALL LENGTH	6990mm   22'11"	
OVERALL WIDTH (MIRRORS FOLDED)	2300mm   7'6"	
OVERALL HEIGHT (EXC TV AERIAL)	2890mm   9'5"	
MTPLM	140BHP MANUAL 3650kg	180BHP AUTO 4400kg
MAX USER PAYLOAD	501kg	1251kg

### MILEO 286

- 4 BELTS
- 4 BERTHS
- ISOFIX

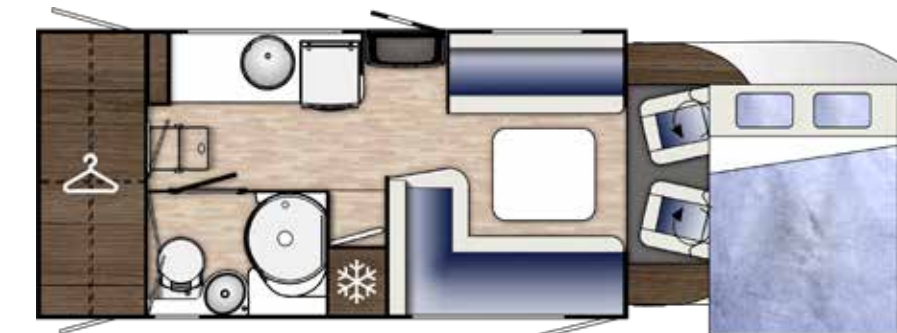

OVERALL LENGTH	6950mm   22'8"	
OVERALL WIDTH (MIRRORS FOLDED)	2300mm   7'6"	
OVERALL HEIGHT (EXC TV AERIAL)	2890mm   9'5"	
MTPLM	140BHP MANUAL 3650kg	180BHP AUTO 4400kg
MAX USER PAYLOAD	519kg	1269kg

### MILEO 282

- 4 BELTS
- 4 BERTHS
- ISOFIX

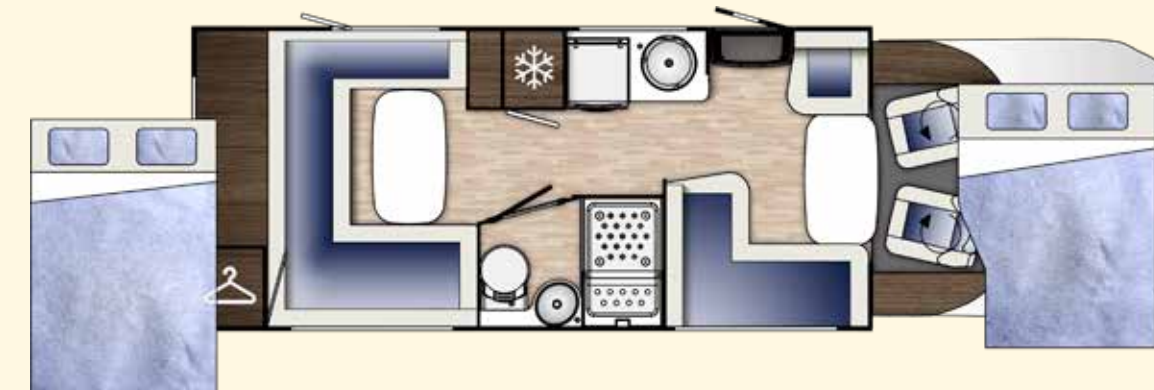

OVERALL LENGTH	7390mm   24'2"	
OVERALL WIDTH (MIRRORS FOLDED)	2300mm   7'6"	
OVERALL HEIGHT (EXC TV AERIAL)	2890mm   9'5"	
MTPLM	140BHP MANUAL 3650kg	180BHP AUTO 4400kg
MAX USER PAYLOAD	434kg	1184kg

### MILEO 294

- 4 BELTS
- 4 BERTHS
- ISOFIX

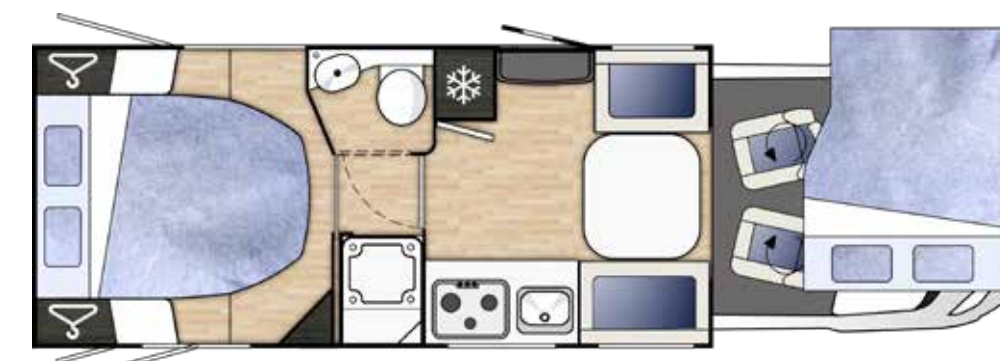

OVERALL LENGTH	7390mm   24'2"	
OVERALL WIDTH (MIRRORS FOLDED)	2300mm   7'6"	
OVERALL HEIGHT (EXC TV AERIAL)	2890mm   9'5"	
MTPLM	140BHP MANUAL 3650kg	180BHP AUTO 4400kg
MAX USER PAYLOAD	400kg	1146kg

03. MILEO FEATURES



**CHOOSE FROM A 3650KG EURO 6E FIAT 140BHP MANUAL WITH 6 SPEED GEARBOX OR 4400KG 180BHP 9 SPEED AUTOMATIC CHASSIS**  
Ensuring a comfortable driving experience with the latest driving features.



**SECURE HABITATION DOOR WITH REMOTE CENTRAL LOCKING**  
For additional security all Mileo motorhomes feature habitation doors with remote central locking systems with windows and flyscreens.



**PIONEER TOUCH SCREEN 9" DAB RADIO WITH SAT NAV & INTEGRATED REAR VIEW CAMERA**  
Make your way to your holiday destination with ease and with the latest audio technology.



**EXTERIOR BBQ AND SHOWER POINTS**  
From washing off a muddy dog to grilling an el fresco dinner, this couldn't be easier thanks to the functionality of the external BBQ and shower points.



**NCC APPROVED WITH FULL UK SPECIFICATION**  
Your Mileo motorhome has been rigorously tested to meet all NCC approval standards to be certified safe for you and your family as well as being legal for use on UK roads.



**SPACE-SAVING ELECTRIC DROP DOWN BED OPTIONS**  
Benimar have expertly designed the Mileo range to include a number of versatile and space saving bed options. Both comfortable and spacious, there are many bed configurations to choose from.



**CAB AIR-CONDITIONING, ADAPTIVE CRUISE CONTROL WITH ABS, ESP TRACTION CONTROL AND HILL ASSIST**  
Drive with the ultimate comfort thanks to the inclusion of the latest driver assistance technology including Lane Centering, Attention Assist and Pedestrian Detection.

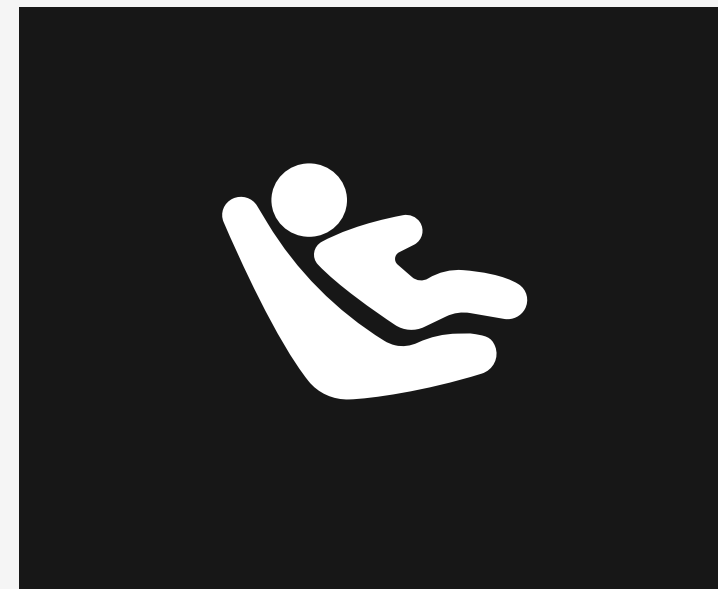

**REAR ISOFIX TRAVEL SEATS**  
Rear travel seats come with Isofix fittings for peace of mind travel for children.



**ELECTRIC AND HEATED WING MIRRORS**  
Mileo door mirrors are electrically heated eliminating ice and condensation build-up quickly to help you see more clearly in any weather.

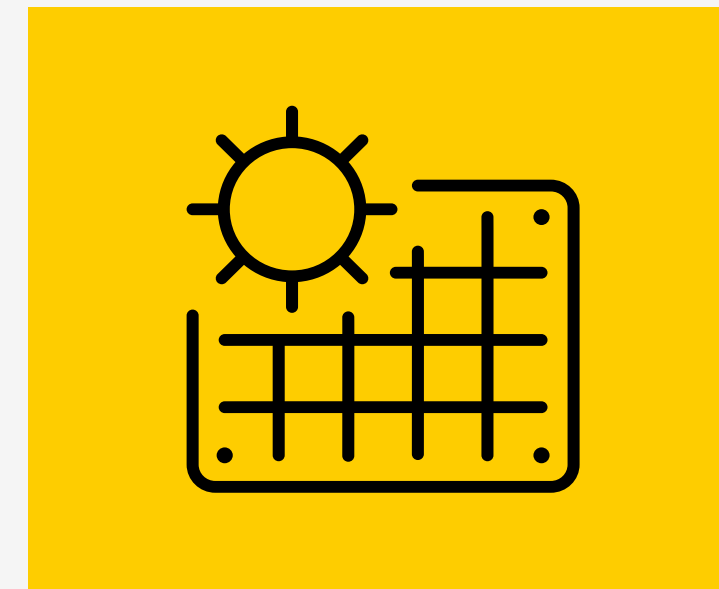

**200W SOLAR PANEL**  
The Solar Panel can ensure your battery life lasts longer. Being self-sufficient helps you enjoy the freedom a motorhome brings.

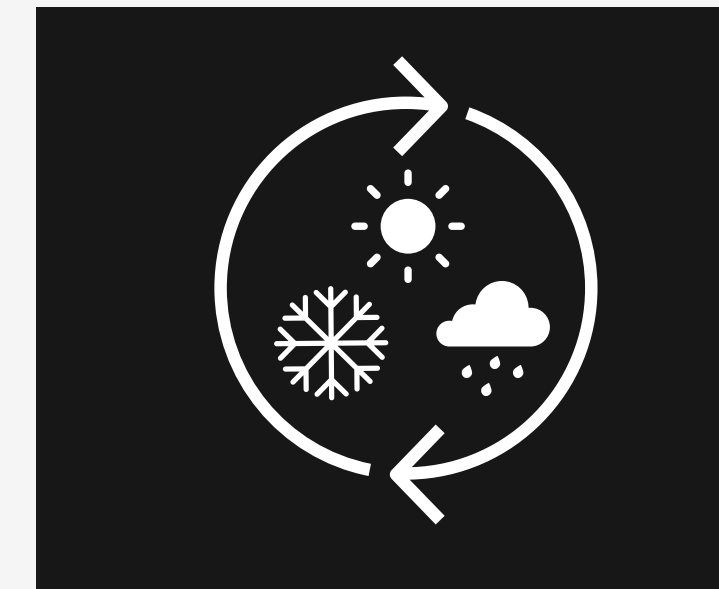

**GRADE III FULLY INSULATED NCC EN1645-1**  
Enjoy the perfect climate 365 days a year. All Mileo motorhomes have achieved Grade III classification for heating and thermal protection.



**ALLOY WHEELS WITH FULL SPARE**  
Stylish and practical. Having a full spare wheel means you can carry on your journey safely in the event of a punctured tyre.



OVERVIEW

MILEO RANGE

FEATURES

WEIGHTS & DIMENSIONS

MILEO GALLERY

CONSTRUCTION

ABOUT BENIMAR

DEALER NETWORK





## 04. MILEO FEATURES

### CHASSIS

- Choice of 140bhp Euro 6E Manual with 6 speed gearbox or 180bhp 9 speed Automatic Engine with AdBlue Technology inc ABS brakes, ESP Traction Control & Hill Assist
- 2 year chassis warranty
- 60 litre fuel tank (90 litre on selected models)

### DRIVER COMFORT

- Automatic Cab air conditioning
- Automatic climate control
- Cab reading lights
- Adjustable steering wheel
- Fully upholstered & swivel captain chairs with two arm rests & height adjustment
- Door pockets & bottle holders
- 12v lighter sockets & USB port
- Aluminium dashboard kit
- Rear corner steadies
- Concertina blinds on doors & windscreen
- Gear stick & steering wheel in leather finish
- Removable carpets including entrance mat
- High resilience seat foam & backrests (130mm/5")
- 2 double USB sockets located behind driver's seat
- Wireless charging

### DRIVER SAFETY

- NCC approval & full UK specification
- Driver & passenger air bags
- Cruise control
- ABS, ESP, Traction control, hill assist & curve assist
- Adaptive Cruise Control
- Lane Centering
- Intelligent Speed Assist
- Attention Assist
- Lane Assist
- Traffic Sign Recognition
- Pedestrian Detection
- Rear axle width of 1980mm for improved stability
- Remote central locking of cab doors & immobiliser
- Isofix rear travel seats
- Full LED headlights
- Alloy wheels plus full spare on all models
- Electric cab windows
- Heated & electric wing mirrors
- Automatic headlights & windscreen wipers
- Colour coded front bumper
- Rear bumper with LED lights
- Electric handbrake
- Tyre pressure monitoring system

### AUDIO SYSTEM

- Media function controls on steering wheel
- MP3 player, USB connection & Bluetooth handsfree
- On/off isolator switch for radio
- Rear speakers
- Wireless charging
- 9" Pioneer DAB radio with Apple CarPlay(USB/WiFi), Google Android Auto (USB/WiFi) Radio FM RDS / DAB+Bluetooth (HFP/Audio) and rear observation camera

### BODY CONSTRUCTION

- Remote locking habitation door on UK side with window & flyscreen
- LED awning light
- External shower point
- External BBQ point
- GRP & 99% wood free construction
- 25mm XPS insulation on sidewalls
- 53mm XPS insulation on floor & roof
- High impact, scratch resistant flooring
- 100 litre fresh water tank isolated & heated with level sensor
- 105 litre waste water tank isolated & heated with level sensor
- Three point seat belts to all designated passenger seats
- High & low fixing points for optional rear mounted cycle rack
- Spacious rear garage with ample storage for leisure equipment with lighting (selected models)
- ABS lower moulded rear panel with integral lights
- High level brake light
- Colour coded side skirts
- High quality double glazed opening windows with night-latch ventilation
- Flyscreens & blinds on all windows
- Gas bottle compartment
- Gas regulator suitable for butane or propane

### LIVING AREA

- Truma iNet X control panel
- Entrance light
- Dometic Deluxe windows
- 'Malaga' stylish furniture with secure positive catches on all furniture doors with soft closing hinges
- Rooflights
- Space-saving electric dropdown beds with removable aluminium ladder (selected models)
- Skyview rooflight
- Multi directional sliding table (selected models)
- TV bracket
- New furniture design with LED lights

### WASHROOM

- Thetford cassette toilet with electric flush & 18 litre wheeled holding tank
- Chrome finish brass mixer taps & shower head
- Rooflight with flyscreen
- Towel holder
- Washbasin with single door cupboard below
- Fully separate shower
- Bathroom accessories
- Illuminated mirror (selected models)

### KITCHEN

- Extractor hood
- Decorative kitchen lights
- Metal drawer runners with soft closing system
- Dual fuel gas & electric hob with glass lid with oven & grill
- Stainless steel sink with glass lid
- Microwave oven
- 145 litre fridge/freezer with automatic energy selection (excl 286)
- 135 litre fridge/freezer (286)
- Granite effect kitchen work top
- Work top extension
- Illuminated spice rack

### ELECTRICS, GAS & PLUMBING

- 3 x 220v sockets
- 3 x 12v sockets
- TV aerial
- Mains consumer unit with mains isolator
- 12v fuse board with battery recharger
- Large & easy to read 12v control panel near to the entrance door
- Low energy consumption LED lighting
- Truma combi 6kw heating & water system which operates on gas or electric
- Pressurized fresh water system with self-filling pump
- Isolation taps for gas appliances
- 200W Solar panel
- Fan rooflight
- USB A and C Sockets
- Grade III Winter pack incl:
  - Insulated & heated waste tanks
  - Insulated external pipes
  - External thermal screen cover
  - External fridge vent covers
- CO2 alarm
- Smoke alarm

### SECURITY SYSTEMS

- Trafficmaster Trackstar S7 Tracker with 1 years free subscription
- Manufacturer Immobiliser



WATCH VIDEOS



VIRTUAL TOURS



PRESS REVIEWS



OVERVIEW

MILEO RANGE

FEATURES

WEIGHTS & DIMENSIONS

MILEO GALLERY

CONSTRUCTION

ABOUT BENIMAR

DEALER NETWORK



## 05. WEIGHTS & DIMENSIONS

MODEL	MILEO 243		MILEO 282		MILEO 286		MILEO 294	
ENGINE	140BHP MANUAL	180BHP AUTOMATIC	140BHP MANUAL	180BHP AUTOMATIC	140BHP MANUAL	180BHP AUTOMATIC	140BHP MANUAL	180BHP AUTOMATIC
BERTHS (SLEEPING POSITIONS)	4		4		4		4	
DESIGNATED PASSENGER SEATS (INC DRIVER)	4		4		4		4	
OVERALL LENGTH	6990MM / 22'11"		7390MM / 24'2"		6950MM / 22'8"		7390MM / 24'1"	
OVERALL WIDTH (MIRRORS FOLDED)	2330MM / 7'6"		2330MM / 7'6"		2330MM / 7'6"		2330MM / 7'6"	
OVERALL WIDTH (MIRRORS EXTENDED)	2750MM / 9'0"		2750MM / 9'0"		2750MM / 9'0"		2750MM / 9'0"	
OVERALL HEIGHT (EXC TV AERIAL)	2890MM / 9'5"		2890MM / 9'5"		2890MM / 9'5"		2890MM / 9'5"	
INTERNAL HEIGHT (MAX)	2110MM / 6'9"		2110MM / 6'9"		2110MM / 6'9"		2110MM / 6'9"	
MAXIMUM PERMISSIBLE LADEN MASS (A)	3650KG	4400KG	3650KG	4400KG	3650KG	4400KG	3650KG	4400KG
MASS IN RUNNING ORDER (B)	3149KG		3216KG		3131KG		3254KG	
MAXIMUM USER PAYLOAD (C) (A-B)	501KG	1251KG	434KG	1184KG	519KG	1269KG	400KG	1146KG
MAXIMUM TRAILER WEIGHT	1750KG		1750KG		1750KG		1750KG	
GROSS TRAIN WEIGHT	5400KG	6150KG	5400KG	6150KG	5400KG	6150KG	5400KG	6150KG
BED SIZES								
DROP DOWN BED	1400MM X 1900MM 4'6" X 6'2"		1400MM X 1900MM 4'6" X 6'2"		1400MM X 1900MM 4'6" X 6'2"		1400MM X 1900MM 4'6" X 6'2"	
FRONT DOUBLE	-		1400MM X 1900MM 4'6" X 6'2"		1300MM X 2100MM 4'3" X 6'9"		-	
REAR DOUBLE	1390MM X 2000MM 4'6" X 6'6"		-		-		1500MM X 2000MM 4'9" X 6'6"	
REAR GARAGE DIMENSIONS								
REAR GARAGE APERTURE DIMENSIONS#	945/1215MM (H) X 1410MM (W) X 2175MM (D)		1510MM (H) X 510MM (W) X 1510MM (D)		1190MM (H) X 805MM (W) X 2175MM (D)		826/1034MM (H) X 846MM (W) X 2175MM (D)	
REAR GARAGE MAX LOAD LIMIT	225KG		225KG		225KG		225KG	

**Data & accuracy:** The contents of this publication are as accurate as possible at the time of going to press, but this information should not be regarded as an infallible guide to current specifications, nor does it constitute an offer for the sale of any particular vehicle. Details of performance, dimensions and weights are subject to minor deviations within manufacturer tolerance limits (max +/- 5%). The Mass In Running Order (MIRO) - Weight of the Motorhome equipped to the manufacturer's standard specification including essential habitational equipment. The MIRO the mass of the unladen vehicle, including an allowance for the driver (assumed 75 kg) and a 90% full fuel tank. The MIRO is calculated with the fresh water tank empty. If you travel with water in the freshwater tank then the User Payload will reduce accordingly. Maximum User Payload includes Personal Effects Payload, conventional load and the Optional Equipment Payload. Please ensure that you've allowed for the masses of all items you intend to carry in the Motorhome. All data is calculated using metric weights and measurements. The imperial figures quoted are conversions thereof and have been rounded to the nearest inch. All dimensions have a tolerance of +/- 25mm. Your Motorhome weights have been calculated with all water tanks empty and we recommend you travel with all water tanks empty. Heights are measured on an unladen vehicle excluding any roof aerial. The maximum weight capacity for an electric drop down bed is 250kg, fixed rear beds have a limit of 250kg, overcab beds are 250kg and bunkbeds 100kg. # Garage dimensions quoted are "aperture" height and width and interior garage dimensions may vary.



OVERVIEW

MILEO RANGE

FEATURES

WEIGHTS &  
DIMENSIONS

MILEO  
GALLERY

CONSTRUCTION

ABOUT  
BENIMAR

DEALER  
NETWORK





06. GALLERY

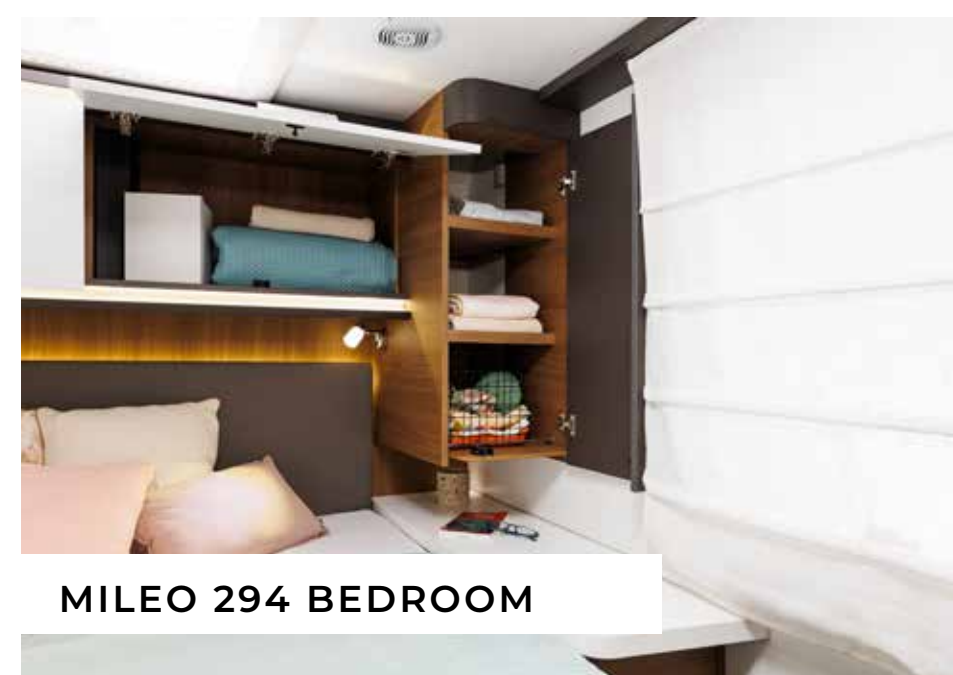
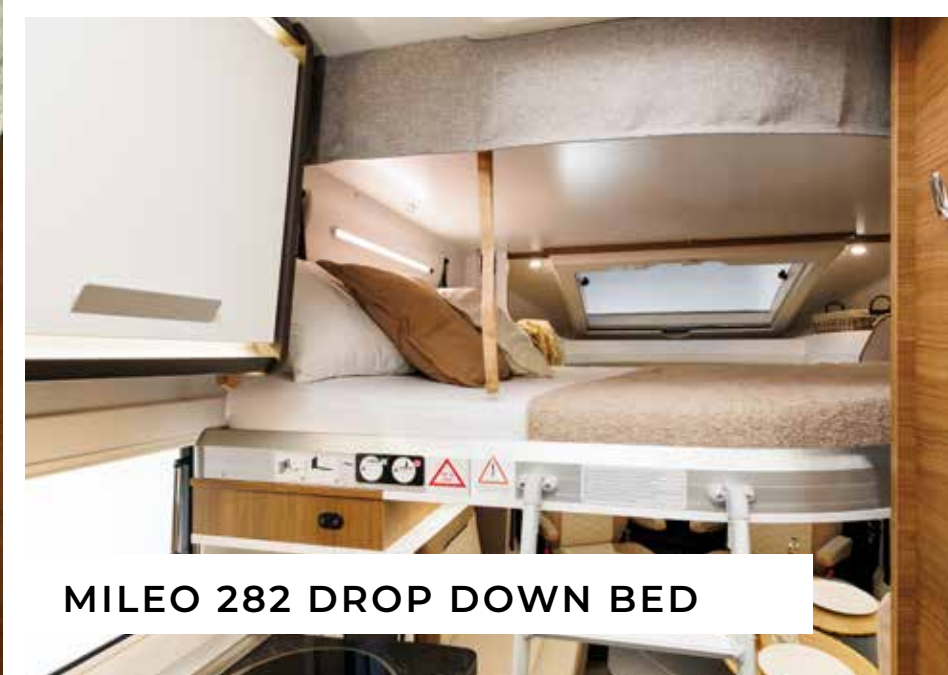
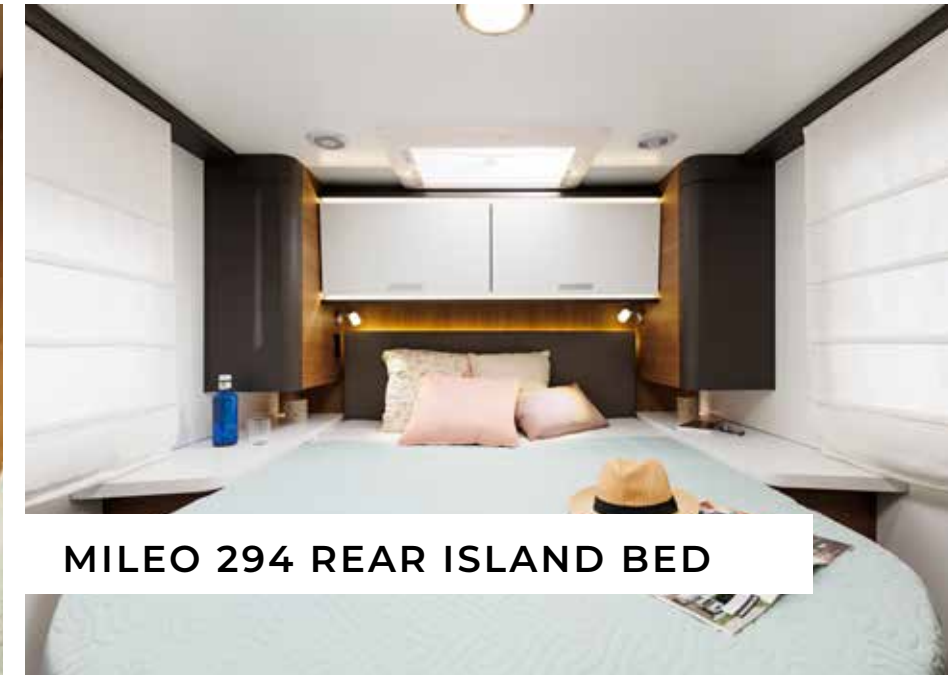
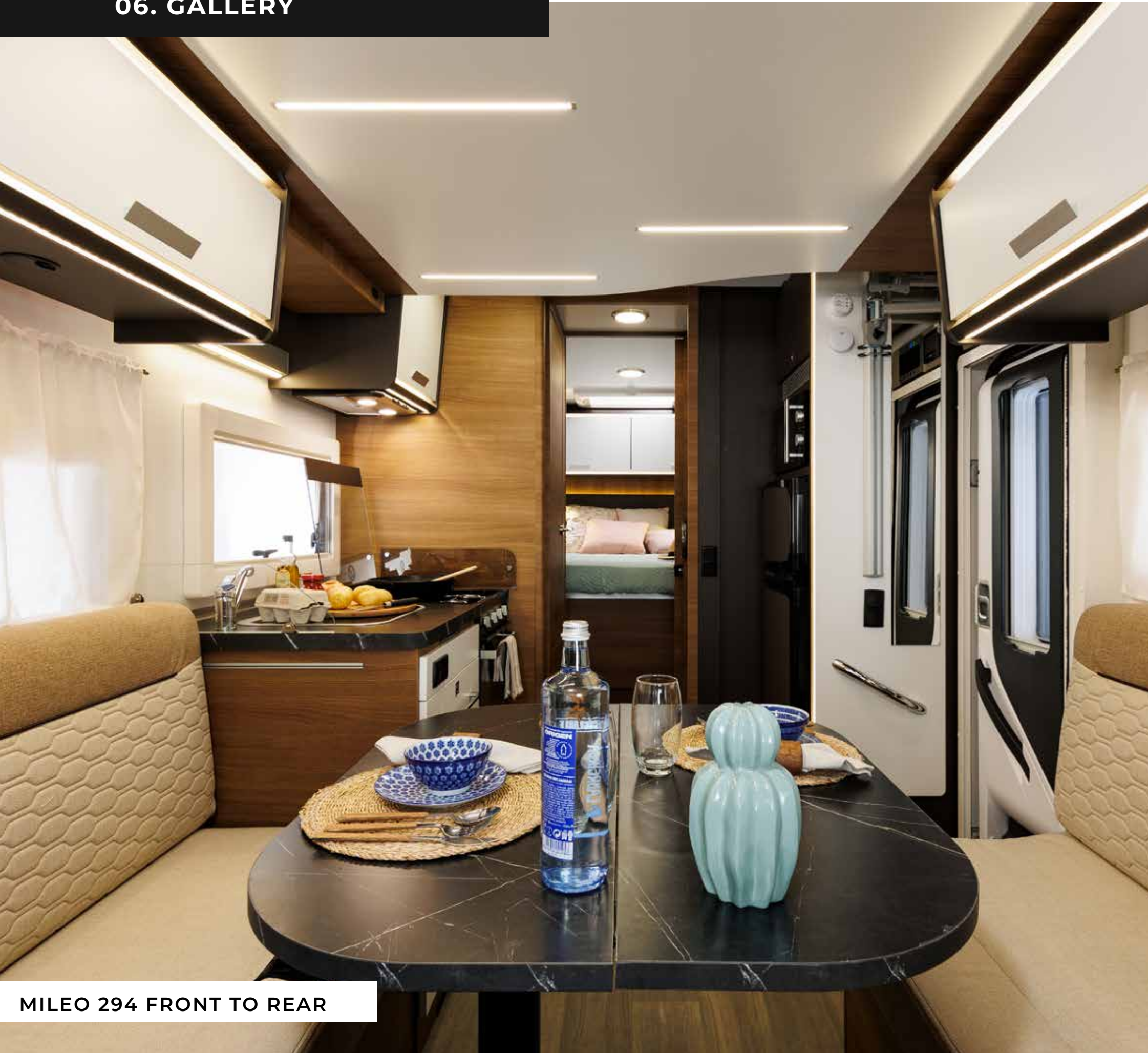

OVERVIEW

MILEO RANGE

FEATURES

WEIGHTS & DIMENSIONS

MILEO GALLERY

CONSTRUCTION

ABOUT BENIMAR

DEALER NETWORK





07. GALLERY



MILEO 282 SPICE RACK



MILEO 282 FRONT LOUNGE



OVERVIEW

MILEO RANGE

FEATURES

WEIGHTS & DIMENSIONS

MILEO GALLERY

CONSTRUCTION

ABOUT BENIMAR

DEALER NETWORK





## 08. MILEO CONSTRUCTION

The ISB (Isolation System Benimar) is a key feature in Benimar motorhomes, designed to provide superior insulation, comfort, and durability. This system helps maintain an optimal internal climate by reducing heat loss in colder months and keeping the interior cool during warmer weather. The materials and construction methods used in the ISB system also enhance the longevity of the motorhome, ensuring it stands up to the rigors of travel while providing a cozy living environment. Overall, it's a vital aspect of what makes Benimar motorhomes appealing to travelers seeking both comfort and reliability.



### GRP and 99% Wood-Free Construction

The almost complete elimination of wood in the bodywork structure and using insulating and damp-proof materials not only enhances durability but also improves energy efficiency and comfort. This approach can significantly extend the lifespan of your motorhome, making it a wise investment for long-term adventures.

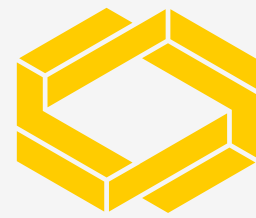

### Insulation and Fuel Efficiency

The floor, roof and walls of your motorhome are constructed using XPS materials which have been proven to be extremely effective at insulating. Plus, its lightweight nature helps maintain the overall weight of the motorhome, which is essential for fuel efficiency and handling.



### Grade III Fully Insulated NCC EN1645-1

Grade III classification for heating and thermal protection means Benimar motorhomes are built to withstand various weather conditions, ensuring comfort all year round. Whether you're exploring the great outdoors or parked in a cozy spot, you can enjoy a pleasant climate inside 365 days a year.



# FIAT

### Fiat Ducato Euro 6E Engine

Easy to drive, safe and ready to assist you in every challenge, always adapting to your needs. Fiat Ducato engines are effective in terms of fuel consumption and emissions, plus they are dynamic and environmentally friendly ensuring a comfortable driving experience with the latest driving features.

## WARRANTY



When you choose a Benimar motorhome you have the reassurance of knowing your vehicle has been designed and constructed to give you years of enjoyable, worry free touring.

## 5 YEARS WATER INGRESS GUARANTEE

Benimar are confident in their construction process and every motorhome comes with a 5-year water ingress guarantee. This guarantee covers the damages that are due to an abnormal modification of the original bodyshell waterproofing.

## 2 YEARS HABITATION GUARANTEE

The guarantee covers the labour and parts supplied to replace or repair those found to be faulty completely free of charge for a period of 24 months from the date of registration of the vehicle.

## 2 YEARS FIAT CHASSIS WARRANTY

All Benimar motorhomes registered in the UK benefit from a Fiat 2 Year Unlimited Warranty. The Fiat Professional Authorised Network guarantees the vehicle base against manufacturing defects for a period of 24 months from the initial registration date without mileage limits. With 1 Year Fiat Assist Breakdown Recovery from the date of registration

For full warranty details please visit:

[www.marquisleisure.co.uk/warranty](http://www.marquisleisure.co.uk/warranty)



OVERVIEW

MILEO RANGE

FEATURES

WEIGHTS &  
DIMENSIONS

MILEO  
GALLERY

CONSTRUCTION

ABOUT  
BENIMAR

DEALER  
NETWORK







# benimar

Benimar has been producing motorhomes for more than 50 years. Their reputation for quality and innovation has allowed them to expand significantly, reaching a global network of over 100 dealers from Europe to New Zealand. This growth reflects their commitment to providing versatile and reliable motorhomes that cater to a variety of leisure needs. Whether for family adventures or solo journeys, Benimar offers something for everyone.

Benimar motorhomes, part of the Trigano Group, are crafted in Peñíscola under the Mediterranean sun. The production facility spans 40,000 m<sup>2</sup> and utilizes high-tech machinery and innovative technologies to ensure quality and performance. This combination of advanced manufacturing and a beautiful setting reflects their commitment to creating reliable and comfortable motorhomes.

Marquis collaborates closely with Benimar to create an exclusive range of well-equipped motorhomes, all featuring NCC Approval and adhering to full UK specifications. This partnership ensures high-quality vehicles designed for comfort and performance on the road.

Benimar's commitment to reliability, quality, and strength is underscored by its ISO 9001 and ISO 14001 certifications. These certifications reflect a dedication to consistently meeting customer expectations while adhering to high standards in product quality and environmental management. This assurance enhances trust in their products and showcases their focus on continuous improvement and sustainability.



OVERVIEW

MILEO RANGE

FEATURES

WEIGHTS & DIMENSIONS

MILEO GALLERY

CONSTRUCTION

ABOUT BENIMAR

DEALER NETWORK





10. YOUR BENIMAR DEALER

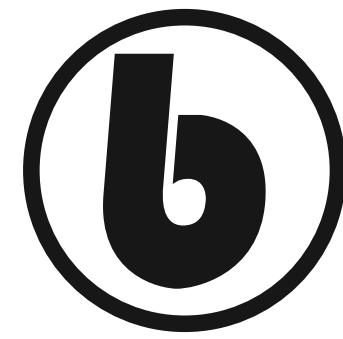

AT YOUR LOCAL BENIMAR MILEO DEALER



The UK's Largest Dealer Network

Marquis is the exclusive distributor for the Benimar Mileo brand in England and work alongside our dealer partners in Scotland, Ireland and New Zealand. If you're looking for more information about our products, services, or anything regarding Benimar motorhomes, get in touch today with your local Benimar Mileo dealer.

From the moment you order your new motorhome, through to delivery and beyond, our branches and dealer partners are dedicated to making your purchase and maintenance experience as hassle-free as possible.

**MARQUIS LANCASHIRE**  
Riversway Leisure Village |  
Chain Caul Road |  
Docklands | Preston |  
Lancashire | PR2 2PD

T: 01772 731 313

**MARQUIS GLOUCESTERSHIRE**  
Mill Avon Holiday Park |  
Gloucester Road |  
Tewkesbury |  
Gloucs | GL20 5SW

T: 01684 296 222

**MARQUIS SOUTH YORKSHIRE**  
Rotherham Road |  
Dinnington | Sheffield  
South Yorkshire |  
S25 3RF

T: 01909 495 900

**MARQUIS DORSET**  
41-45 Old Wareham Rd |  
Poole |  
Dorset |  
BH12 4QN

T: 01202 738 777

**CALDER CAMPERS**  
Camps Industrial Estate |  
East Calder | Livingston |  
Scotland |  
EH27 8DF

T: 01506 880 411

**MARQUIS SUFFOLK**  
Farthing Road |  
Sproughton |  
Ipswich | Suffolk  
IP1 5AP

T: 01473 747 675

**MARQUIS SURREY/SUSSEX**  
Station Approach |  
Gomshall |  
Surrey |  
GU5 9NX

T: 01483 203 335

**MARQUIS NORTHANTS**  
The Causeway |  
Great Billing |  
Northampton |  
Northants | NN3 9EX

T: 01604 402 888

**MARQUIS BERKSHIRE**  
Oxford Road |  
Chieveley |  
Nr Newbury |  
Berkshire | RG20 8RU

T: 01635 248 888

**CAMPER NI**  
67 Moira Road |  
Hillsborough |  
Co. Down |  
BT26 6DX

T: 028 9268 2220

**MARQUIS HAMPSHIRE**  
Winchester Road |  
Lower Upham |  
Nr Southampton |  
Hampshire | SO32 1HA

T: 01489 860 666

**MARQUIS EXETER**  
Sandygate |  
Clyst Road |  
Exeter |  
Devon | EX2 7JL

T: 01392 446 250

**MARQUIS DEVON (Plymouth)**  
Lee Mill |  
Ivybridge |  
Nr Plymouth |  
Devon | PL21 9EG

T: 01752 892 977

**MARQUIS DURHAM**  
Durham Road |  
Birtley | Chester Le Street |  
County Durham |  
DH3 2QZ

T: 0191 492 2480

**TRAILITE CHRISTCHURCH**  
10 Innovation Road |  
Islington |  
Christchurch |  
8042

T: 03 222 2067

**TRAILITE AUCKLAND**  
77 Paerata Road |  
Pukekohe |  
Auckland |  
2120

T: 09 238 6869



PLEASE CALL BEFORE TRAVELLING TO CHECK STOCK AT YOUR LOCAL DEALER.



[www.marquisleisure.co.uk](http://www.marquisleisure.co.uk)



[www.caldercampers.co.uk](http://www.caldercampers.co.uk)



[www.camperni.com](http://www.camperni.com)



[www.trailite.co.nz](http://www.trailite.co.nz)



OVERVIEW

MILEO RANGE

FEATURES

WEIGHTS &  
DIMENSIONS

MILEO  
GALLERY

CONSTRUCTION

ABOUT  
BENIMAR

DEALER  
NETWORK

