



PRIMERO

CREATED FOR ADVENTURE



WATCH VIDEOS



VIRTUAL TOURS



PRESS REVIEWS



OVERVIEW

PRIMERO RANGE

FEATURES

WEIGHTS & DIMENSIONS

PRIMERO GALLERY

CONSTRUCTION

ABOUT BENIMAR

DEALER NETWORK



01. OVERVIEW

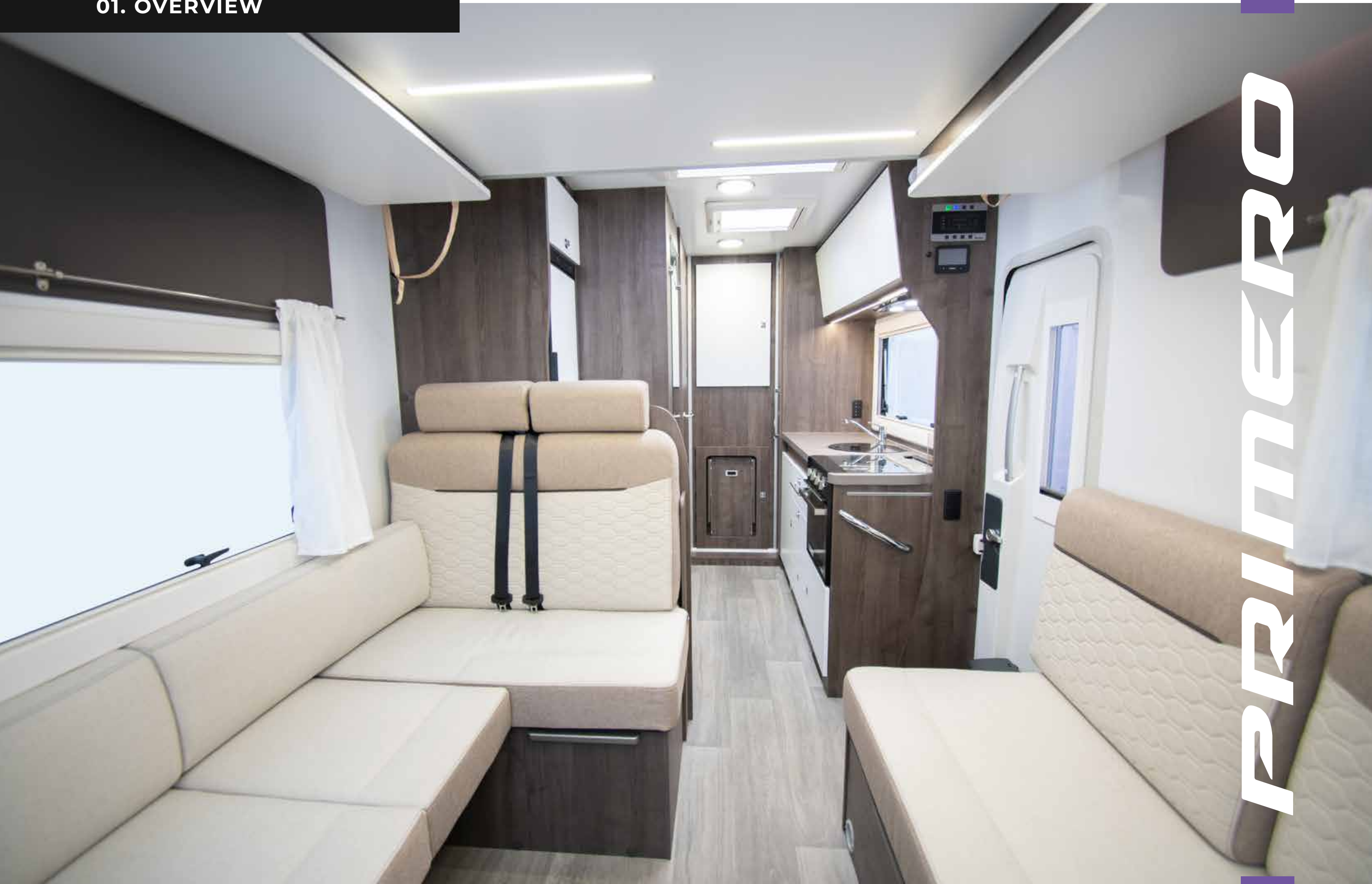

PRIMERO

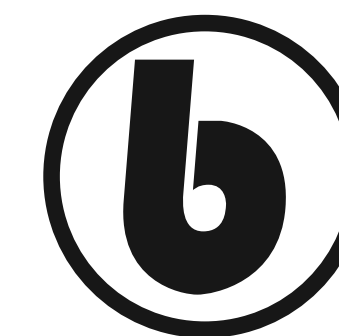

Discover the exclusive Primero range of 2-4 berth motorhomes, designed with various Low Profile layouts to suit your travel needs. These redesigned models come packed with features to enhance your holiday experience, making it easy to enjoy your leisure time.

Primero is your go-to option for a budget-friendly motorhome that doesn't compromise on quality or comfort. With an MTPLM weight of 3500kg, these Low Profile motorhomes can be effortlessly driven by anyone with a full UK driving licence, regardless of age. Plus, chassis upgrades are available for those seeking an increased payload.

Enjoy your adventures with Primero—where affordability meets luxury!

[VIEW OUR NATIONWIDE STOCK](#)

- WATCH VIDEOS
- 360° VIRTUAL TOURS
- PRESS REVIEWS



OVERVIEW

PRIMERO RANGE

FEATURES

WEIGHTS & DIMENSIONS

PRIMERO GALLERY

CONSTRUCTION

ABOUT BENIMAR

DEALER NETWORK



02. PRIMERO RANGE

FIAT

The new Fiat engine delivers a powerful, comfortable, and safe driving experience, ensuring you can enjoy every journey. For added convenience, an optional Fiat automatic gearbox is available as a cost option, making your travels even smoother.



Primero motorhomes come with a standard MTPLM of 3500kg, making them easy to drive for anyone with a full UK driving licence, regardless of age. If you need a bit more capacity, there's an option to upgrade to 3650kg for an increased payload, providing you with even more flexibility.



GRP and 99% Wood-Free Construction. Benimar motorhomes offer the almost complete elimination of wood in the bodywork structure. The use of damp-proof materials, which are effective at insulating, guarantee the vehicle lasts longer.

- WATCH VIDEOS
- VIRTUAL TOURS
- PRESS REVIEWS



OVERVIEW

PRIMERO RANGE

FEATURES

WEIGHTS & DIMENSIONS

PRIMERO GALLERY

CONSTRUCTION

ABOUT BENIMAR

DEALER NETWORK



PRIMERO 201

- 4 BELTS
- 2 BERTHS
- ISOFIX



OVERALL LENGTH	5950mm 19'5"	
OVERALL WIDTH (MIRRORS FOLDED)	2300mm 7'6"	
OVERALL HEIGHT (EXC TV AERIAL)	2890mm 9'5"	
MTPLM	3500kg	3650kg
MAX USER PAYLOAD	Manual 724kg	Manual 874kg
	Auto 674kg	Auto 824kg

PRIMERO 202

- 4 BELTS
- 4 BERTHS
- ISOFIX

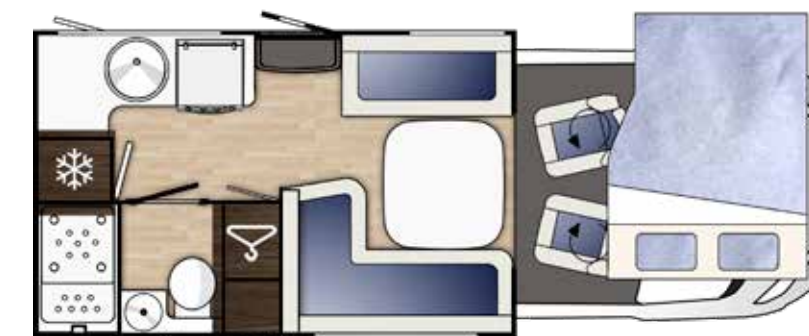

OVERALL LENGTH	5950mm 19'5"	
OVERALL WIDTH (MIRRORS FOLDED)	2300mm 7'6"	
OVERALL HEIGHT (EXC TV AERIAL)	2890mm 9'5"	
MTPLM	3500kg	3650kg
MAX USER PAYLOAD	Manual 621kg	Manual 771kg
	Auto 571kg	Auto 721kg

PRIMERO 286

- 4 BELTS
- 4 BERTHS
- ISOFIX

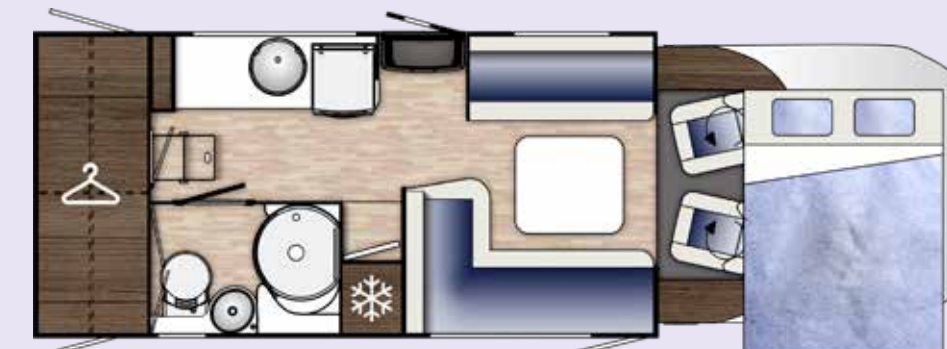

OVERALL LENGTH	6950mm 22'8"	
OVERALL WIDTH (MIRRORS FOLDED)	2300mm 7'6"	
OVERALL HEIGHT (EXC TV AERIAL)	2890mm 9'5"	
MTPLM	3500kg	3650kg
MAX USER PAYLOAD	Manual 469kg	Manual 619kg
	Auto 419kg	Auto 569kg

PRIMERO 282

- 4 BELTS
- 4 BERTHS
- ISOFIX

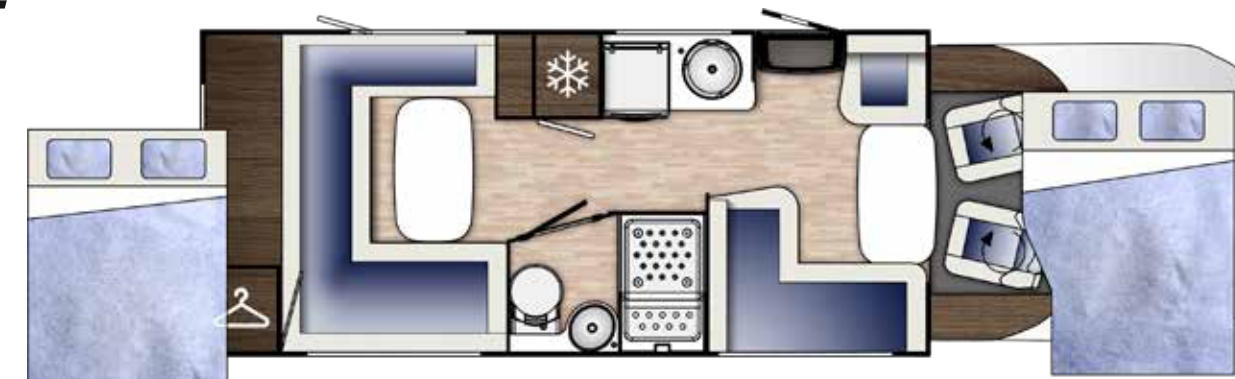

OVERALL LENGTH	7390mm 24'2"	
OVERALL WIDTH (MIRRORS FOLDED)	2300mm 7'6"	
OVERALL HEIGHT (EXC TV AERIAL)	2890mm 9'5"	
MTPLM	3500kg	3650kg
MAX USER PAYLOAD	Manual 434kg	Manual 584kg
	Auto 384kg	Auto 534kg

03. PRIMERO FEATURES



FIAT 140BHP EURO 6E ENGINE WITH ADBLUE TECHNOLOGY WITH OPTIONAL AUTOMATIC

The new generation Fiat engine provides a powerful, comfortable and safe driving experience with an optional Fiat automatic gearbox available as a cost option.



NEW PIONEER TOUCH SCREEN 9" DAB RADIO WITH SAT NAV AND INTEGRATED REAR VIEW CAMERA

Make your way to your holiday destination with ease and with the latest audio technology.

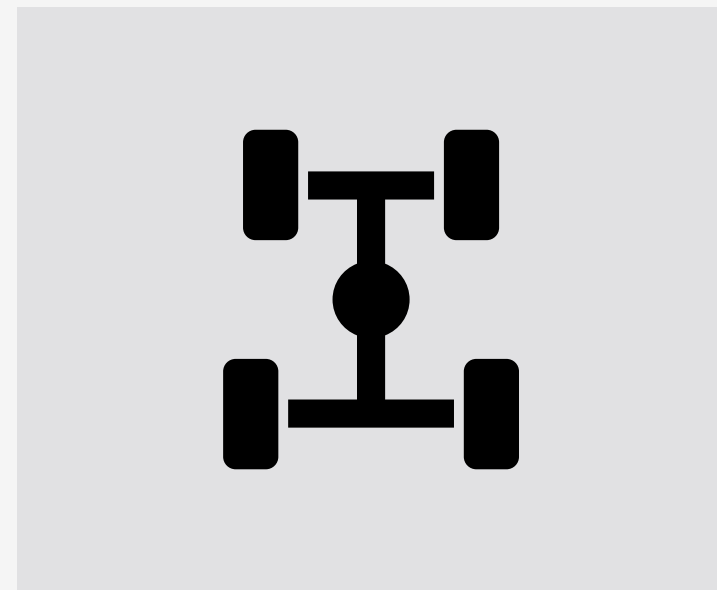

WIDENED REAR TRACK

The increased rear track of the Primero motorhomes enhances stability, ensuring a smoother ride on various terrains. This design also provides greater width for the living unit, maximizing your comfort and space inside.



ALLOY WHEELS WITH FIAT FIX & GO REPAIR KIT

Fix&Go is the world's most advanced tire repair kit, designed to help you quickly and efficiently get back on the road in emergency situations.



NCC APPROVED WITH FULL UK SPECIFICATION

Your Primero motorhome has been rigorously tested to meet all NCC approval standards to be certified safe for you and your family as well as being legal for use on UK roads.



PLENTIFUL BED OPTIONS

Benimar has expertly crafted the Primero range with a variety of versatile bed options to suit different needs including space-saving drop down beds on selected models.



ABS BRAKES, ESP TRACTION CONTROL AND HILL/CURVE/WIND ASSIST

Drive with the ultimate comfort thanks to the inclusion of the latest driver assistance technology.

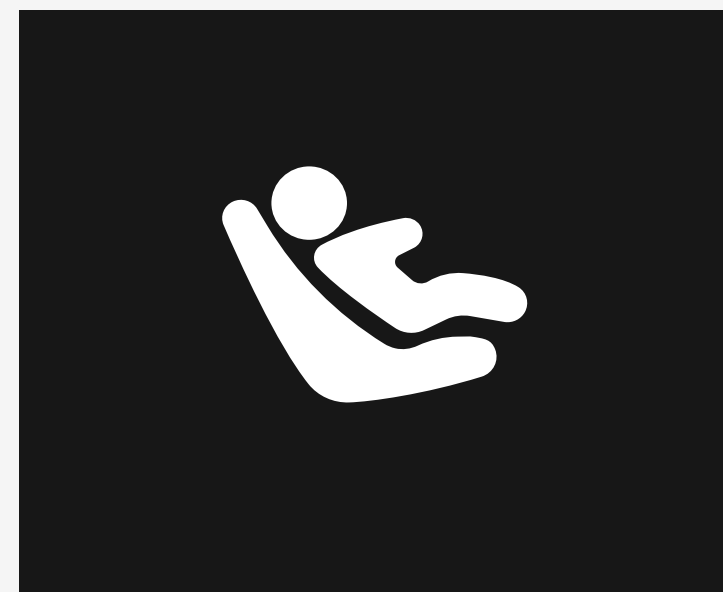

REAR ISOFIX TRAVEL SEATS

Rear travel seats come with Isofix fittings for peace of mind travel for children.



ELECTRIC AND HEATED WING MIRRORS

Primero door mirrors are electrically heated eliminating ice and condensation build-up quickly to help you see more clearly in any weather.



CAB AIR-CONDITIONING AND CRUISE CONTROL

Drive with the ultimate comfort with the inclusion of cab air-conditioning and cruise control.



TRUMA COMBI 6KW HEATING & WATER SYSTEM

The especially lightweight, compact heater ensures pleasant temperatures and operates on gas and electric.



THREE POINT SEAT BELTS TO ALL FORWARD FACING DESIGNATED PASSENGER SEATS

Comfortable safety for all your passengers with fully upholstered swivel captain chairs with two arm rests and height adjustment.



OVERVIEW

PRIMERO RANGE

FEATURES

WEIGHTS & DIMENSIONS

PRIMERO GALLERY

CONSTRUCTION

ABOUT BENIMAR

DEALER NETWORK



04. PRIMERO FEATURES

CHASSIS



- Fiat 140bhp Ducato Euro 6E Engine with 6 speed gearbox with AdBlue technology
- Automatic 8 speed gearbox
- available as a cost option
- 2 year chassis warranty
- 60 litre fuel tank

DRIVER COMFORT



- Cab Air conditioning
- Adjustable steering wheel
- Electric windows & mirrors
- On board computer
- Fully upholstered swivel seats with two arm rests & height adjustment
- Door pockets & bottle holders
- Gear stick and steering wheel in leather finish
- Media functions on steering wheel
- 12v lighter socket & 1 USB port

DRIVER SAFETY



- NCC approval & full UK specification
- Driver & passenger air bags
- Cruise control
- ABS Brakes, ESP Traction Control with Hill/Curve/Wind Assist
- Wireless charging
- USB port
- Rear Isofix Travel Seats
- Rear axle width of 1980mm for improved stability
- Remote central locking of cab doors & immobiliser
- Alloy wheels
- Puncture repair kit - Fix & Go
- Electric cab windows
- Heated & electric wing mirrors
- Rear bumper with LED lights

AUDIO SYSTEM



- 9" Pioneer DAB radio with Apple CarPlay(USB/WiFi), Google Android Auto (USB/WiFi) Radio FM RDS / DAB+Bluetooth (HFP/Audio) and rear observation camera
- DAB antenna in external mirror
- On/off isolator switch for radio

BODY CONSTRUCTION



- Habitation door on UK side
- GRP & 99% wood free construction
- 25mm XPS insulation on sidewalls
- 53mm XPS insulation on floor & roof
- High impact, scratch resistant flooring
- 100 litre fresh water tank isolated & heated with level sensor
- 105 litre waste water tank with level sensor
- Three point seat belts to all designated forward facing passenger seats
- High & low fixing points for optional rear mounted cycle rack
- Single key locking for habitation doors
- ABS lower moulded rear panel with integral lights
- High level brake light
- Colour coded side skirts
- Removable entrance mat
- High quality double glazed opening windows with night-latch ventilation
- Windows with cassette blinds and flyscreens
- Gas bottle compartment
- Gas regulator suitable for butane or propane
- Entrance light
- External awning light

LIVING AREA



- Dometic Deluxe windows Pamplona and white style furniture
- Dometic Midi heki rooflights
- Multi positional space saving drop down beds with removable aluminium ladder on selected models
- 'Ronda' stylish fabrics as standard with 'Paradore' at cost option
- Secure positive catches on all furniture doors with soft closing hinges
- Skyview rooflight Cab curtains
- Multi directional sliding table (selected models)

WASHROOM



- Thetford cassette toilet with electric flush & 18 litre wheeled holding tank
- Chrome finish brass mixer taps & shower head
- Rooflight with flyscreen
- Towel holder
- New Washbasin unit with single door cupboard below
- Fully separate shower
- Bathroom accessories

KITCHEN



- Metal drawer runners with soft closing system
- Gas hob with glass lid, oven & extractor hood
- Stainless steel sink with glass lid
- Illuminated spice rack
- Work top extension
- 145 litre fridge/freezer with automatic energy selection (excl 286)
- 135 litre fridge/freezer (286)

ELECTRICS, GAS & PLUMBING



- 2 x 220v sockets
- 2 x 12v sockets
- Mains consumer unit with mains isolator
- Truma combi 6kw heating & water system which operates on gas or electric
- Isolation taps for gas appliances
- External LED awning light
- 16 amp battery charger
- CO2 alarm
- Smoke alarm
- USB Socket

SECURITY SYSTEMS



- Manufacturer Immobiliser
- Engine Immobiliser



WATCH VIDEOS



VIRTUAL TOURS



PRESS REVIEWS



OVERVIEW

PRIMERO RANGE

FEATURES

WEIGHTS & DIMENSIONS

PRIMERO GALLERY

CONSTRUCTION

ABOUT BENIMAR

DEALER NETWORK



05. WEIGHTS & DIMENSIONS

MODEL	PRIMERO 201				PRIMERO 202				PRIMERO 282				PRIMERO 286			
ENGINE	140BHP MANUAL		140BHP AUTOMATIC		140BHP MANUAL		140BHP AUTOMATIC		140BHP MANUAL		140BHP AUTOMATIC		140BHP MANUAL		140BHP AUTOMATIC	
BERTHS (SLEEPING POSITIONS)	2				4				4				4			
DESIGNATED PASSENGER SEATS (INC DRIVER)	4				4				4				4			
OVERALL LENGTH	5950MM / 19'5"				5950MM / 19'5"				7390MM / 24'2"				6950MM / 22'8"			
OVERALL WIDTH (MIRRORS FOLDED)	2330MM / 7'6"				2330MM / 7'6"				2330MM / 7'6"				2330MM / 7'6"			
OVERALL WIDTH (MIRRORS EXTENDED)	2750MM / 9'0"				2750MM / 9'0"				2750MM / 9'0"				2750MM / 9'0"			
OVERALL HEIGHT (EXC TV AERIAL)	2890MM / 9'5"				2890MM / 9'5"				2890MM / 9'5"				2890MM / 9'5"			
INTERNAL HEIGHT (MAX)	2110MM / 6'9"				2110MM / 6'9"				2110MM / 6'9"				2110MM / 6'9"			
MAXIMUM PERMISSIBLE LADEN MASS (A)	3500KG	3650KG	3500KG	3650KG	3500KG	3650KG	3500KG	3650KG	3500KG	3650KG	3500KG	3650KG	3500KG	3650KG	3500KG	3650KG
MASS IN RUNNING ORDER (B)	2776KG		2826KG		2879KG		2929KG		3066KG	3116KG	3116KG		3031KG		3081KG	
MAXIMUM USER PAYLOAD (C) (A-B)	724KG	874KG	674KG	824KG	621KG	771KG	571KG	721KG	434KG	584KG	384KG	534KG	469KG	619KG	419KG	569KG
MAXIMUM TRAILER WEIGHT	2000KG		1750KG		2000KG		1750KG		2000KG		1750KG		2000KG		1750KG	
GROSS TRAIN WEIGHT	5500KG		5400KG		5500KG		5400KG		5500KG		5400KG		5500KG		5400KG	
BED SIZES																
DROP DOWN BED	-				1390MM X 1900MM 4'6" X 6'2"				1400MM X 1900MM 4'6" X 6'2"				1400MM X 1900MM 4'6" X 6'2"			
FRONT DOUBLE	-				1400MM X 2100MM 4'6" X 6'9"				1400MM X 1900MM 4'6" X 6'2"				1300MM X 2100MM 4'3" X 6'9"			
REAR DOUBLE	1390MM X 2000MM 4'6" X 6'6"				-				-				-			
REAR GARAGE DIMENSIONS																
REAR GARAGE APERTURE DIMENSIONS#	976MM (H) X 761MM (W) X 2175MM (D)				-				1510MM (H) X 510MM (W) X 1510MM (D)				1190MM (H) X 805MM (W) X 2175MM (D)			
REAR GARAGE MAX LOAD LIMIT	225KG				225KG				225KG				225KG			

Data & accuracy: The contents of this publication are as accurate as possible at the time of going to press, but this information should not be regarded as an infallible guide to current specifications, nor does it constitute an offer for the sale of any particular vehicle. Details of performance, dimensions and weights are subject to minor deviations within manufacturer tolerance limits (max +/- 5%). The Mass In Running Order (MIRO) - Weight of the Motorhome equipped to the manufacturer's standard specification including essential habitation equipment. The MIRO is the mass of the unladen vehicle, including an allowance for the driver (assumed 75 kg) and a 90% full fuel tank. The MIRO is calculated with the fresh water tank empty. If you travel with water in the freshwater tank then the User Payload will reduce accordingly. Maximum User Payload includes Personal Effects Payload, conventional load and the Optional Equipment Payload. Please ensure that you've allowed for the masses of all items you intend to carry in the Motorhome. All data is calculated using metric weights and measurements. The imperial figures quoted are conversions thereof and have been rounded to the nearest inch. All dimensions have a tolerance of +/- 25mm. Your Motorhome weights have been calculated with all water tanks empty and we recommend you travel with all water tanks empty. Heights are measured on an unladen vehicle excluding any roof aerial. The maximum weight capacity for an electric drop down bed is 250kg, fixed rear beds have a limit of 250kg, overcab beds are 250kg and bunkbeds 100kg. # Garage dimensions quoted are "aperture" height and width and interior garage dimensions may vary.



OVERVIEW

PRIMERO RANGE

FEATURES

WEIGHTS & DIMENSIONS

PRIMERO GALLERY

CONSTRUCTION

ABOUT BENIMAR

DEALER NETWORK



06. GALLERY



PRIMERO 202 FRONT LOUNGE (OPTIONAL FABRIC)



PRIMERO 202 WARDROBE

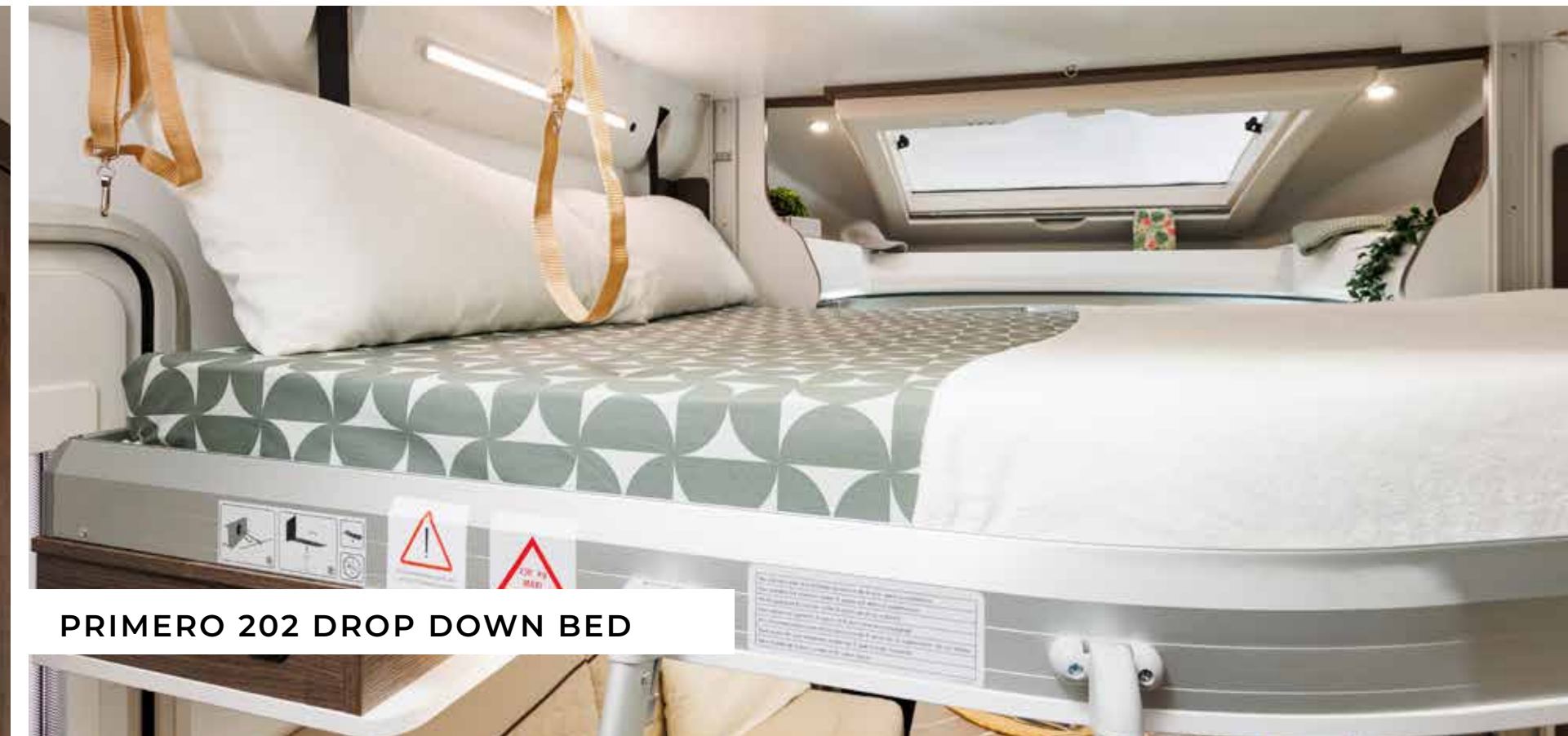

PRIMERO 202 DROP DOWN BED



PRIMERO 286 LIVING AREA



OVERVIEW

PRIMERO RANGE

FEATURES

WEIGHTS & DIMENSIONS

PRIMERO GALLERY

CONSTRUCTION

ABOUT BENIMAR

DEALER NETWORK



07. GALLERY



PRIMERO 286 KITCHEN EXTENSION



PRIMERO 202 GARAGE



PRIMERO 202 WASHROOM



PRIMERO 286 REAR TO FRONT



OVERVIEW

PRIMERO RANGE

FEATURES

WEIGHTS & DIMENSIONS

PRIMERO GALLERY

CONSTRUCTION

ABOUT BENIMAR

DEALER NETWORK



08. MILEO CONSTRUCTION

The ISB (Isolation System Benimar) is a key feature in Benimar motorhomes, designed to provide superior insulation, comfort, and durability. This system helps maintain an optimal internal climate by reducing heat loss in colder months and keeping the interior cool during warmer weather. The materials and construction methods used in the ISB system also enhance the longevity of the motorhome, ensuring it stands up to the rigors of travel while providing a cozy living environment. Overall, it's a vital aspect of what makes Benimar motorhomes appealing to travelers seeking both comfort and reliability.

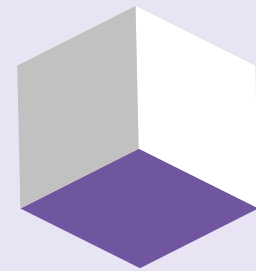

GRP and 99% Wood-Free Construction

The almost complete elimination of wood in the bodywork structure and using insulating and damp-proof materials not only enhances durability but also improves energy efficiency and comfort. This approach can significantly extend the lifespan of your motorhome, making it a wise investment for long-term adventures.

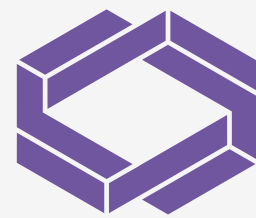

Insulation and Fuel Efficiency

The floor, roof and walls of your motorhome are constructed using XPS materials which have been proven to be extremely effective at insulating. Plus, its lightweight nature helps maintain the overall weight of the motorhome, which is essential for fuel efficiency and handling.

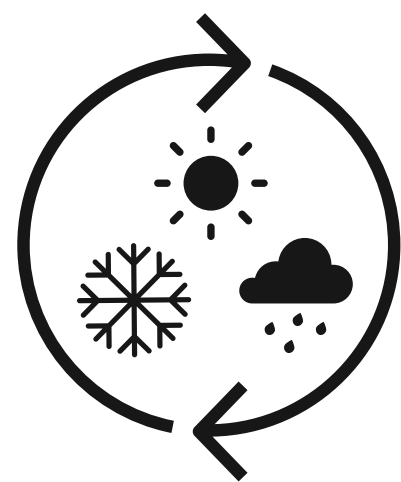

Grade III Fully Insulated NCC EN1645-1

Grade III classification for heating and thermal protection means Benimar motorhomes are built to withstand various weather conditions, ensuring comfort all year round. Whether you're exploring the great outdoors or parked in a cozy spot, you can enjoy a pleasant climate inside 365 days a year.

FIAT

Fiat Ducato Euro 6E Engine

Easy to drive, safe and ready to assist you in every challenge, always adapting to your needs. Fiat Ducato engines are effective in terms of fuel consumption and emissions, plus they are dynamic and environmentally friendly ensuring a comfortable driving experience with the latest driving features.

WARRANTY



When you choose a Benimar motorhome you have the reassurance of knowing your vehicle has been designed and constructed to give you years of enjoyable, worry free touring.

5 YEARS WATER INGRESS GUARANTEE

Benimar are confident in their construction process and every motorhome comes with a 5-year water ingress guarantee. This guarantee covers the damages that are due to an abnormal modification of the original bodysell waterproofing.

2 YEARS HABITATION GUARANTEE

The guarantee covers the labour and parts supplied to replace or repair those found to be faulty completely free of charge for a period of 24 months from the date of registration of the vehicle.

2 YEARS FIAT CHASSIS WARRANTY

All Benimar motorhomes registered in the UK benefit from a Fiat 2 Year Unlimited Warranty. The Fiat Professional Authorised Network guarantees the vehicle base against manufacturing defects for a period of 24 months from the initial registration date without mileage limits. With 1 Year Fiat Assist Breakdown Recovery from the date of registration

For full warranty details please visit:

www.marquisleisure.co.uk/warranty



OVERVIEW

PRIMERO RANGE

FEATURES

WEIGHTS & DIMENSIONS

PRIMERO GALLERY

CONSTRUCTION

ABOUT BENIMAR

DEALER NETWORK





Benimar

Benimar has been producing motorhomes for more than 50 years. Their reputation for quality and innovation has allowed them to expand significantly, reaching a global network of over 100 dealers from Europe to New Zealand. This growth reflects their commitment to providing versatile and reliable motorhomes that cater to a variety of leisure needs. Whether for family adventures or solo journeys, Benimar offers something for everyone.

Benimar motorhomes, part of the Trigano Group, are crafted in Peñíscola under the Mediterranean sun. The production facility spans 40,000 m² and utilizes high-tech machinery and innovative technologies to ensure quality and performance. This combination of advanced manufacturing and a beautiful setting reflects their commitment to creating reliable and comfortable motorhomes.

Marquis collaborates closely with Benimar to create an exclusive range of well-equipped motorhomes, all featuring NCC Approval and adhering to full UK specifications. This partnership ensures high-quality vehicles designed for comfort and performance on the road.

Benimar's commitment to reliability, quality, and strength is underscored by its ISO 9001 and ISO 14001 certifications. These certifications reflect a dedication to consistently meeting customer expectations while adhering to high standards in product quality and environmental management. This assurance enhances trust in their products and showcases their focus on continuous improvement and sustainability.



OVERVIEW

PRIMERO RANGE

FEATURES

WEIGHTS & DIMENSIONS

PRIMERO GALLERY

CONSTRUCTION

ABOUT BENIMAR

DEALER NETWORK



10. YOUR BENIMAR DEALER



Buy



Collect



Service

AT YOUR LOCAL BENIMAR PRIMERO DEALER



The UK's Largest Dealer Network

Marquis is the exclusive distributor for the Benimar Primero brand in England and work alongside our dealer partners in Scotland, Ireland and New Zealand. If you're looking for more information about our products, services, or anything regarding Benimar motorhomes, get in touch today with your local Benimar Primero dealer.

From the moment you order your new motorhome, through to delivery and beyond, our branches and dealer partners are dedicated to making your purchase and maintenance experience as hassle-free as possible.

MARQUIS LANCASHIRE

Riversway Leisure Village | Chain Caul Road | Docklands | Preston | Lancashire | PR2 2PD

T: 01772 731 313

MARQUIS GLOUCESTERSHIRE

Mill Avon Holiday Park | Gloucester Road | Tewkesbury | Gloucs | GL20 5SW

T: 01684 296 222

MARQUIS SOUTH YORKSHIRE

Rotherham Road | Dinnington | Sheffield | South Yorkshire | S25 3RF

T: 01909 495 900

MARQUIS DORSET

41-45 Old Wareham Rd | Poole | Dorset | BH12 4QN

T: 01202 738 777

CALDER CAMPERS

Camps Industrial Estate | East Calder | Livingston | Scotland | EH27 8DF

T: 01506 880 411

MARQUIS SUFFOLK

Farthing Road | Sproughton | Ipswich | Suffolk | IP1 5AP

T: 01473 747 675

MARQUIS SURREY/SUSSEX

Station Approach | Gomshall | Surrey | GU5 9NX

T: 01483 203 335

MARQUIS NORTHANTS

The Causeway | Great Billing | Northampton | Northants | NN3 9EX

T: 01604 402 888

MARQUIS BERKSHIRE

Oxford Road | Chieveley | Nr Newbury | Berkshire | RG20 8RU

T: 01635 248 888

CAMPER NI

67 Moira Road | Hillsborough | Co. Down | BT26 6DX

T: 028 9268 2220

DUBLIN MOTORHOMES

Unit T35 | Rowan Ave | Stillorgan Business Park | Sandyford | Dublin | A94 K8Y6

T: 01-2939304

MARQUIS HAMPSHIRE

Winchester Road | Lower Upham | Nr Southampton | Hampshire | SO32 1HA

T: 01489 860 666

MARQUIS EXETER

Sandygate | Clyst Road | Exeter | Devon | EX2 7JL

T: 01392 446 250

MARQUIS DEVON (Plymouth)

Lee Mill | Ivybridge | Nr Plymouth | Devon | PL21 9EG

T: 01752 892 977

MARQUIS DURHAM

Durham Road | Birtley | Chester Le Street | County Durham | DH3 2QZ

T: 0191 492 2480

TRAILITE CHRISTCHURCH

10 Innovation Road | Islington | Christchurch | 8042

T: 03 222 2067

TRAILITE AUCKLAND

77 Paerata Road | Pukekohe | Auckland | 2120

T: 09 238 6869

PLEASE CALL BEFORE TRAVELLING TO CHECK STOCK AT YOUR LOCAL DEALER.



www.marquisleisure.co.uk



www.camperni.com



www.trailite.co.nz



www.caldercampers.co.uk



www.dublinmotorhomes.ie

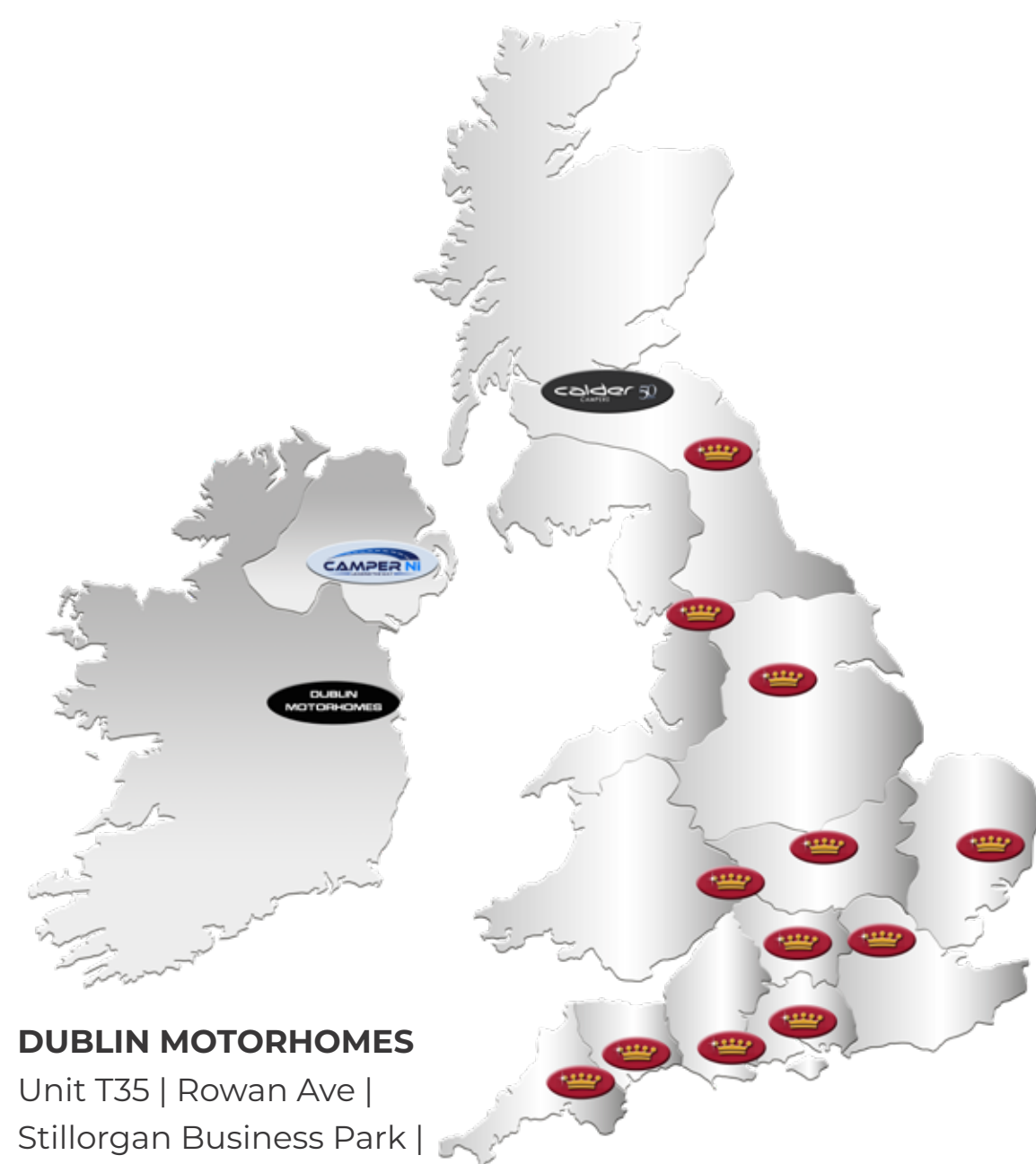

OVERVIEW

PRIMERO RANGE

FEATURES

WEIGHTS & DIMENSIONS

PRIMERO GALLERY

CONSTRUCTION

ABOUT BENIMAR

DEALER NETWORK

