

TESSORO

CREATED FOR ADVENTURE



WATCH VIDEOS



VIRTUAL TOURS



PRESS REVIEWS



OVERVIEW

TESSORO RANGE

FEATURES

WEIGHTS & DIMENSIONS

TESSORO GALLERY

CONSTRUCTION

ABOUT BENIMAR

DEALER NETWORK



01. OVERVIEW

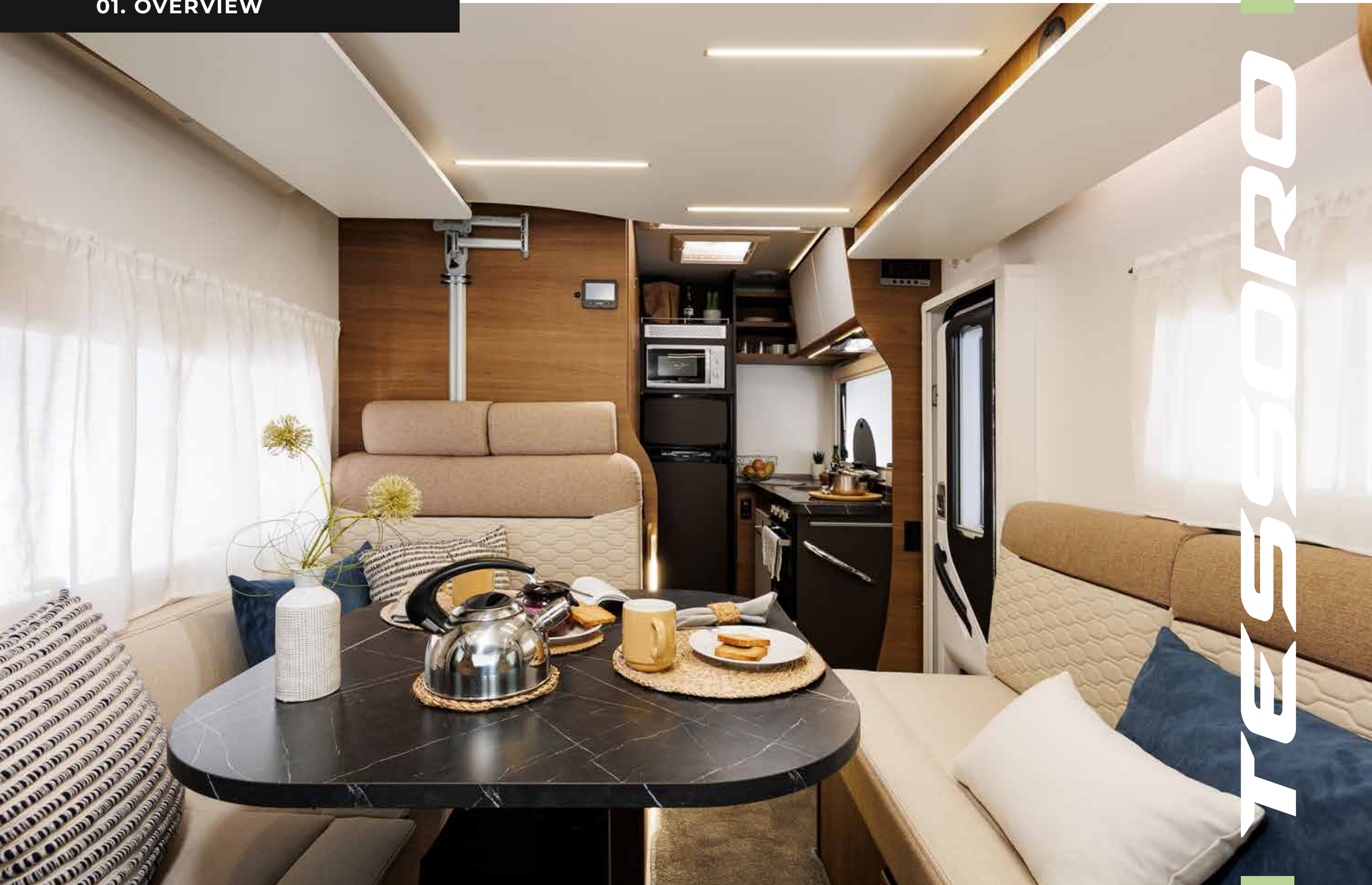

TESSORO

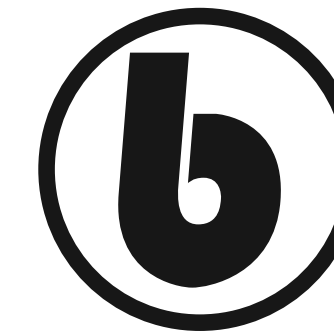

The Benimar Tessoro range truly sets the stage for unforgettable adventures on the open road. With its sleek silver grey cab and matching bumper, it effortlessly turns heads while ensuring a comfortable ride.

Inside, you'll find a high specification with functional storage for all your holiday essentials, ensuring a comfortable home away from home, no matter where your travels take you.

No matter your destination, the Tessoro provides a perfect blend of comfort and practicality, ensuring you feel right at home wherever you roam.

[VIEW OUR NATIONWIDE STOCK](#)



WATCH VIDEOS



VIRTUAL TOURS



PRESS REVIEWS



OVERVIEW

TESSORO RANGE

FEATURES

WEIGHTS & DIMENSIONS

TESSORO GALLERY

CONSTRUCTION

ABOUT BENIMAR

DEALER NETWORK



02. TESSORO RANGE



All Tessoro models come with the Ford Transit 165bhp Euro 6E Engine with AdBlue technology with daytime running lights. A Ford Automatic gearbox is also available as a cost option.



Your new Tessoro motorhome is protected 24/7 with the Trafficmaster Trackstar S7 Tracker with One Years Subscription included.



GRP and 99% Wood-Free Construction. Benimar motorhomes offer the almost complete elimination of wood in the bodywork structure. The use of damp-proof materials, which are effective at insulating, guarantee the vehicle lasts longer



WATCH VIDEOS



VIRTUAL TOURS



PRESS REVIEWS



OVERVIEW

TESSORO RANGE

FEATURES

WEIGHTS & DIMENSIONS

TESSORO GALLERY

CONSTRUCTION

ABOUT BENIMAR

DEALER NETWORK



TESSORO 413

4 BELTS 4 BERTHS ISOFIX



OVERALL LENGTH	6410mm 21'1"
OVERALL WIDTH (MIRRORS FOLDED)	2300mm 7'6"
OVERALL HEIGHT (EXC TV AERIAL)	2890mm 9'5"
MTPLM	3500kg
MAX USER PAYLOAD	MANUAL 475kg AUTO 425kg

TESSORO 840

4 BELTS 3 BERTHS ISOFIX

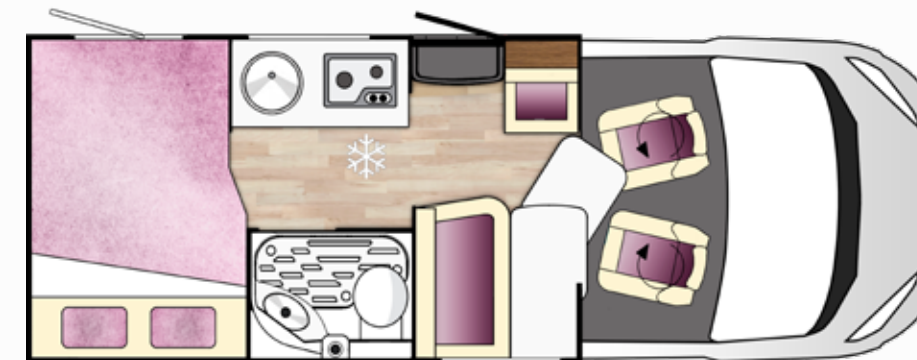

OVERALL LENGTH	5990mm 19'6"
OVERALL WIDTH (MIRRORS FOLDED)	2140mm 7'0"
OVERALL HEIGHT (EXC TV AERIAL)	2760mm 9'0"
MTPLM	3500kg
MAX USER PAYLOAD	MANUAL 715kg AUTO 665kg

TESSORO 481

4 BELTS 4 BERTHS ISOFIX

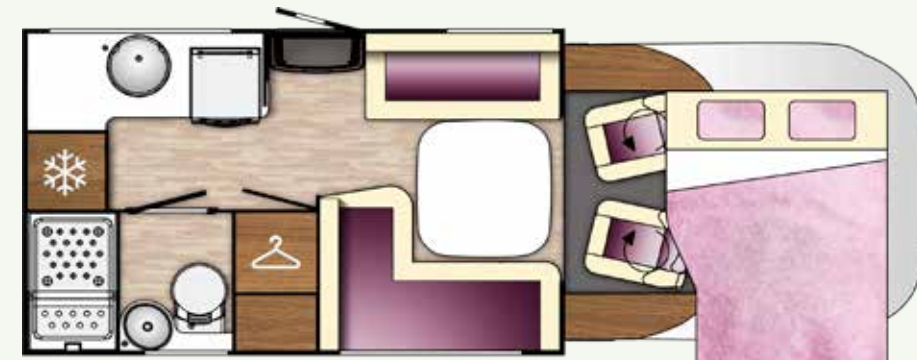

OVERALL LENGTH	5980mm 19'7"
OVERALL WIDTH (MIRRORS FOLDED)	2300mm 7'6"
OVERALL HEIGHT (EXC TV AERIAL)	2890mm 9'5"
MTPLM	3500kg
MAX USER PAYLOAD	MANUAL 552kg AUTO 502kg

TESSORO 861

4 BELTS 3 BERTHS ISOFIX

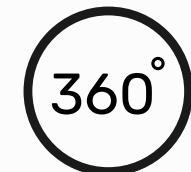

OVERALL LENGTH	6990mm 21'9"
OVERALL WIDTH (MIRRORS FOLDED)	2140mm 7'0"
OVERALL HEIGHT (EXC TV AERIAL)	2760mm 9'0"
MTPLM	3500kg
MAX USER PAYLOAD	MANUAL 660kg AUTO 610kg

TESSORO 487

4 BELTS 4 BERTHS ISOFIX

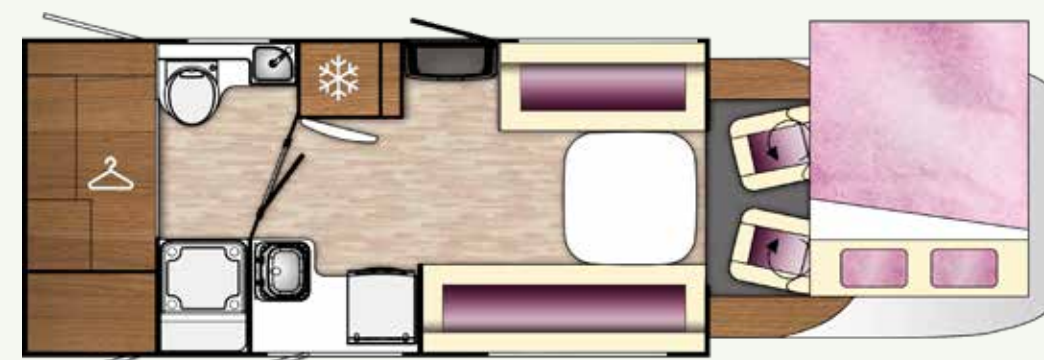

OVERALL LENGTH	6980mm 22'9"
OVERALL WIDTH (MIRRORS FOLDED)	2300mm 7'6"
OVERALL HEIGHT (EXC TV AERIAL)	2890mm 9'5"
MTPLM	3500kg
MAX USER PAYLOAD	MANUAL 410kg AUTO 360kg

TESSORO 463

4 BELTS 4 BERTHS ISOFIX



OVERALL LENGTH	7380mm 24'2"
OVERALL WIDTH (MIRRORS FOLDED)	2300mm 7'6"
OVERALL HEIGHT (EXC TV AERIAL)	2890mm 9'5"
MTPLM	3500kg
MAX USER PAYLOAD	MANUAL 360kg AUTO 310kg

03. TESSORO FEATURES



FORD EURO 6E CHASSIS WITH 165BHP ENGINE WITH ADBLUE TECHNOLOGY

Ensuring a comfortable driving experience with the latest driving features and Automatic gearbox available as a cost option.



ALL TESSORO MOTORHOMES COME WITH A MTPLM WEIGHT OF 3500KG

All Tessoro motorhomes can be driven by anyone holding a full UK driving licence with ease and regardless of age.



FORD TOUCH SCREEN 12" DAB RADIO WITH SAT NAV AND INTEGRATED REAR CAMERA

Effortless smartphone integration for two mobile phones simultaneously, including Apple Carplay & Android Auto, conversational voice recognition, cloud-based connectivity, & more. New Ford SYNC@4+++ brings you a more seamless, more connected, more personalised driving experience.



EXTERIOR BBQ AND SHOWER POINTS

From washing off a muddy dog to grilling an el fresco dinner, this couldn't be easier thanks to the functionality of the external BBQ and shower points.



NCC APPROVED WITH FULL UK SPECIFICATION

Your Tessoro motorhome has been rigorously tested to meet all NCC approval standards to be certified safe for you and your family as well as being legal for use on UK roads.



MULTI POSITIONAL DROP DOWN BED OPTIONS ON SELECTED MODELS

Benimar have expertly designed the Tessoro range to include a number of versatile and space saving bed options. Both comfortable and spacious, there are many bed configurations to choose from.



CAB AIR-CONDITIONING, ADAPTIVE CRUISE CONTROL WITH ABS, ESP TRACTION CONTROL AND HILL ASSIST

Drive with the ultimate comfort thanks to the inclusion of the latest driver assistance technology including Pre-Collision Assist, Lane-Keeping Alert and Speed Sign recognition.

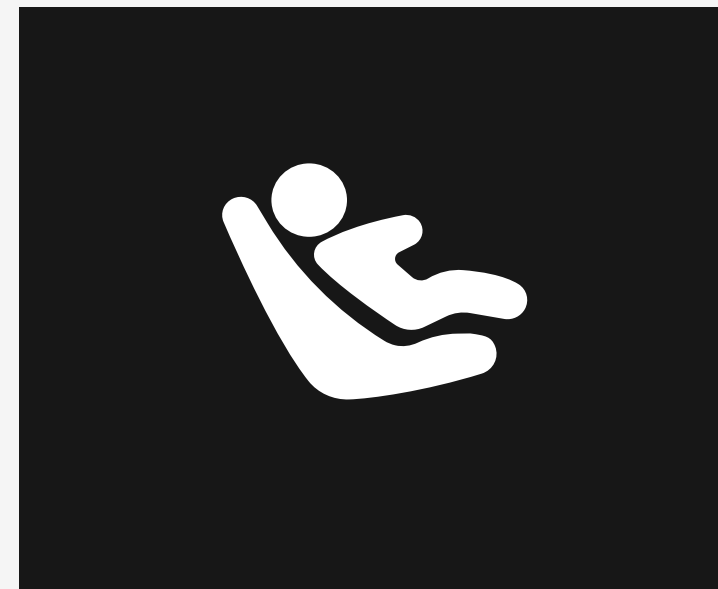

REAR ISOFIX TRAVEL SEATS

Rear travel seats come with Isofix fittings for peace of mind travel for children.



AUTOMATIC HEADLIGHTS AND WINDSCREEN WIPERS

Provide a convenient, automatic way to light the road and keep the windscreen clear in poor conditions.

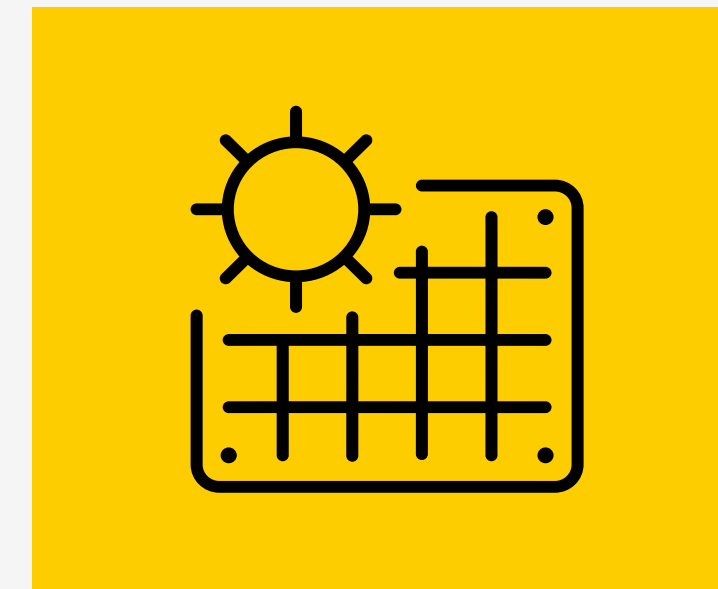

200W SOLAR PANEL

The Solar Panel can ensure your battery life lasts longer. Being self-sufficient helps you enjoy the freedom a motorhome brings.

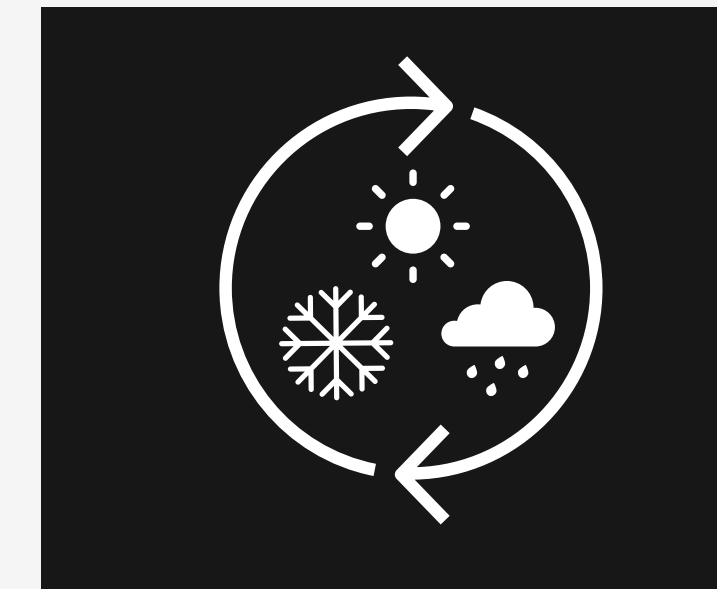

GRADE III FULLY INSULATED NCC EN1645-1

Enjoy the perfect climate 365 days a year. All Tessoro motorhomes have achieved Grade III classification for heating and thermal protection.



FORDPASS CONNECT

The FordPass free of charge app allows you to stay connected with your Tessoro's Ford Cab wherever you are. Unlock your motorhomes smart side.



OVERVIEW

TESSORO RANGE

FEATURES

WEIGHTS & DIMENSIONS

TESSORO GALLERY

CONSTRUCTION

ABOUT BENIMAR

DEALER NETWORK



04. TESSORO FEATURES

CHASSIS

- Ford Euro 6E Chassis with 165bhp engine with AdBlue technology
- Automatic gearbox as cost option
- 3 year chassis warranty
- 70 litre fuel tank
- Stylish silver grey chassis cab with colour coded bumper
- Daytime running lights

DRIVER COMFORT

- Automatic Cab air conditioning
- Adjustable steering wheel with media controls
- Fully upholstered & heated swivel captain chairs with two arm rests & height adjustment
- Door pockets & bottle holders
- Storage above cab
- 12v lighter sockets & USB port
- Cab reading lights
- Gear stick & steering wheel in leather effect finish with chrome inserts
- Rear corner steadies
- Concertina blinds on doors & windscreen
- Removable carpets including entrance mat
- High resilience seat foam & backrests (130mm/5")
- 1 double USB sockets located behind driver's seat

DRIVER SAFETY

- NCC approval & full UK specification
- Driver & passenger air bags
- Adaptive Cruise control
- ABS, ESP, Traction control, hill assist & curve assist
- Lane-Keeping Alert
- Pre-Collision Assist
- Speed Sign Recognition
- Rear axle width of 1980mm for improved stability (exc 840 & 861)
- Remote central locking of cab doors & immobiliser
- Isofix rear travel seats
- Full LED headlights
- Alloy wheels plus full spare on all models
- Electric cab windows
- Heated & electric wing mirrors
- Automatic headlights & windscreen wipers
- Fast defrost windscreen system

AUDIO SYSTEM

- Media function controls on steering wheel
- Rear speakers
- Ford Touch Screen 12" DAB Radio with Sat Nav and integrated rear view camera plus effortless smartphone integration for two mobile phones simultaneously, including Apple Carplay and Android Auto, conversational voice recognition, cloud-based connectivity, and much more. New Ford SYNC@ 4+++ brings you a more seamless, more connected, more personalised driving experience.

BODY CONSTRUCTION

- Awning light
- Electrical twin locking habitation door on the UK side with window & flyscreen
- External shower point
- External BBQ point
- GRP & 99% wood free construction
- 25mm XPS insulation on sidewalls
- 53mm XPS insulation on floor & roof
- High impact, scratch resistant flooring
- Three point seat belts to all designated passenger seats
- High & low fixing points for optional rear mounted cycle rack
- Spacious rear garage with ample storage for leisure equipment with lighting (selected models)
- High level brake light
- Colour coded side skirts
- High quality double glazed opening windows with night-latch ventilation
- Gas bottle compartment
- Gas regulator suitable for butane or propane

LIVING AREA

- Truma iNet X control panel
- Entrance light
- Dometic Deluxe windows
- Malaga, Raw and White style combination furniture
- Rooflights
- Space-saving electric dropdown beds with removable aluminium ladder (exc 840 & 861)
- Secure positive catches on all furniture doors with soft closing hinges
- Skyview rooflight
- Flyscreens & blinds on all windows
- Multi directional sliding table (selected models)
- TV bracket
- Furniture design with LED lights under drop down beds

WASHROOM

- Thetford cassette toilet with electric flush & 18 litre wheeled holding tank
- Chrome finish brass mixer taps & shower head
- Rooflight with flyscreen
- Towel holder
- Washbasin with single door cupboard below
- Fully separate shower (exc 840 & 861)
- Illuminated mirror (selected models)

KITCHEN

- Extractor hood
- Metal drawer runners with soft closing system
- Dual fuel gas & electric hob with glass lid with oven & grill
- Stainless steel sink with glass lid
- Microwave oven (exc 840 & 861)
- 145 litre fridge/freezer with automatic energy selection (exc 840 & 861)
- 70 litre compressor fridge (840 & 861)
- Granite effect kitchen work top
- Work top extension
- Illuminated spice rack

ELECTRICS, GAS & PLUMBING

- TV aerial
- TV aerial socket
- 3 x 220v sockets
- 3 x 12v sockets
- Mains consumer unit with mains isolator
- 12v fuse board with battery recharger with MPPT Solar Regulator
- Large & easy to read 12v control panel near to the entrance door
- Low energy consumption LED lighting
- 100 litre fresh water tank isolated & heated with level sensor
- 105 litre waste water tank isolated & heated with level sensor
- Truma combi 6kw heating & water system which operates on gas or electric
- Pressurized fresh water system with self-filling pump
- Isolation taps for gas appliances
- 200W Solar panel
- Fan rooflight
- Leisure battery
- CO2 alarm
- Smoke alarm
- USB A and C Sockets
- Grade III Winter pack incl:
 - Insulated & heated waste tanks
 - Insulated external pipes
 - External thermal screen cover
 - External fridge vent covers

SECURITY SYSTEMS

- Trafficmaster Trackstar S7 Tracker with 1 years free subscription
- Manufacturer Immobiliser



WATCH VIDEOS



VIRTUAL TOURS



PRESS REVIEWS



OVERVIEW

TESSORO RANGE

FEATURES

WEIGHTS & DIMENSIONS

TESSORO GALLERY

CONSTRUCTION

ABOUT BENIMAR

DEALER NETWORK



05. WEIGHTS & DIMENSIONS

MODEL	TESSORO 413		TESSORO 463		TESSORO 481		TESSORO 487		TESSORO 840		TESSORO 861	
ENGINE	165BHP MANUAL	165BHP AUTO	165BHP MANUAL	165BHP AUTO	165BHP MANUAL	165BHP AUTO	165BHP MANUAL	165BHP AUTO	165BHP MANUAL	165BHP AUTO	165BHP MANUAL	165BHP AUTO
BERTHS (SLEEPING POSITIONS)	4		4		4		4		3		3	
DESIGNATED PASSENGER SEATS (INC DRIVER)	4		4		4		4		4		4	
OVERALL LENGTH	6410MM / 21'1"		7380MM / 24'2"		5980MM / 19'7"		6980MM / 22'9"		5990MM / 19'6"		6690MM / 21'9"	
OVERALL WIDTH (MIRRORS FOLDED)	2330MM / 7'6"		2330MM / 7'6"		2330MM / 7'6"		2330MM / 7'6"		2140MM / 7'0"		2140MM / 7'0"	
OVERALL WIDTH (MIRRORS EXTENDED)	2750MM / 9'0"		2750MM / 9'0"		2750MM / 9'0"		2750MM / 9'0"		2470MM / 8'1"		2470MM / 8'1"	
OVERALL HEIGHT (EXC TV AERIAL)	2890MM / 9'5"		2890MM / 9'5"		2890MM / 9'5"		2890MM / 9'5"		2760MM / 9'0"		2760MM / 9'0"	
INTERNAL HEIGHT (MAX)	2110MM / 6'9"		2110MM / 6'9"		2110MM / 6'9"		2110MM / 6'9"		1980MM / 6'5"		1980MM / 6'5"	
MAXIMUM PERMISSIBLE LADEN MASS (A)	3500KG		3500KG		3500KG		3500KG		3500KG		3500KG	
MASS IN RUNNING ORDER (B)	3025KG	3075KG	3140KG	3190KG	2948KG	2998KG	3090KG	3140KG	2785KG	2835KG	2840KG	2890KG
MAXIMUM USER PAYLOAD (C) (A-B)	475KG	425KG	360KG	310KG	552KG	502KG	410KG	360KG	715KG	665KG	660KG	610KG
MAXIMUM TRAILER WEIGHT	2000KG		2000KG		2000KG		2000KG		2000KG		2000KG	
GROSS TRAIN WEIGHT	5500KG		5500KG		5500KG		5500KG		5500KG		5500KG	
BED SIZES												
DROP DOWN BED	1390MM X 1900MM 4'6" X 6'2"		1390MM X 1900MM 4'6" X 6'2"		1390MM X 1900MM 4'6" X 6'2"		1390MM X 1900MM 4'6" X 6'2"		-		-	
FRONT BED	-		-		DOUBLE 1400MM X 2100MM 4'6" X 6'9"		DOUBLE 1400MM X 2100MM 4'6" X 6'9"		SINGLE 1810MM X 900MM 5'9" X 2'9"		SINGLE 1810MM X 900MM 5'9" X 2'9"	
REAR DOUBLE	-		-		-		-		1350MM X 1960MM 4'4" X 6'4"		-	
REAR SINGLES	2 X 800MM X 2100MM 2'6" X 6'9"		2 X 800MM X 1900MM 2'6" X 6'2"		-		-		-		1 X 790MM X 1910MM 2'5" X 6'2" 1 X 790MM X 2030MM 2'5" X 6'6"	
REAR GARAGE DIMENSIONS												
REAR GARAGE APERTURE DIMENSIONS#	1045/225 (H) X 840 (W) X 2175 (D)		1130 (H) X 1205 (W) X 2175 (D)		1900/830 (H) X 535 (W) X 380/945 (D)		1300 (H) X 855 (W) X 2175 (D)		1130 (H) X 785 (W) X 2004 (D)		1130 (H) X 785 (W) X 2004 (D)	
REAR GARAGE MAX LOAD LIMIT	225KG		225KG		225KG		225KG		225KG		225KG	

Data & accuracy: The contents of this publication are as accurate as possible at the time of going to press, but this information should not be regarded as an infallible guide to current specifications, nor does it constitute an offer for the sale of any particular vehicle. Details of performance, dimensions and weights are subject to minor deviations within manufacturer tolerance limits (max +/- 5%). The Mass In Running Order (MIRO) - Weight of the Motorhome equipped to the manufacturer's standard specification including essential habitational equipment. The MIRO is the mass of the unladen vehicle, including an allowance for the driver (assumed 75 kg) and a 90% full fuel tank. The MIRO is calculated with the fresh water tank empty. If you travel with water in the freshwater tank then the User Payload will reduce accordingly. Maximum User Payload includes Personal Effects Payload, conventional load and the Optional Equipment Payload. Please ensure that you've allowed for the masses of all items you intend to carry in the Motorhome. All data is calculated using metric weights and measurements. The imperial figures quoted are conversions thereof and have been rounded to the nearest inch. All dimensions have a tolerance of +/- 25mm. Your Motorhome weights have been calculated with all water tanks empty and we recommend you travel with all water tanks empty. Heights are measured on an unladen vehicle excluding any roof aerial. The maximum weight capacity for an electric drop down bed is 250kg, fixed rear beds have a limit of 250kg, overcab beds are 250kg and bunkbeds 100kg. The optional Automatic gearbox on the Ford Chassis will increase the MIRO by 50kg and therefore reduce the user payload by the same amount. # Garage dimensions quoted are "aperture" height and width and interior garage dimensions may vary.



OVERVIEW

TESSORO
RANGE

FEATURES

WEIGHTS &
DIMENSIONS

TESSORO
GALLERY

CONSTRUCTION

ABOUT
BENIMAR

DEALER
NETWORK



06. GALLERY

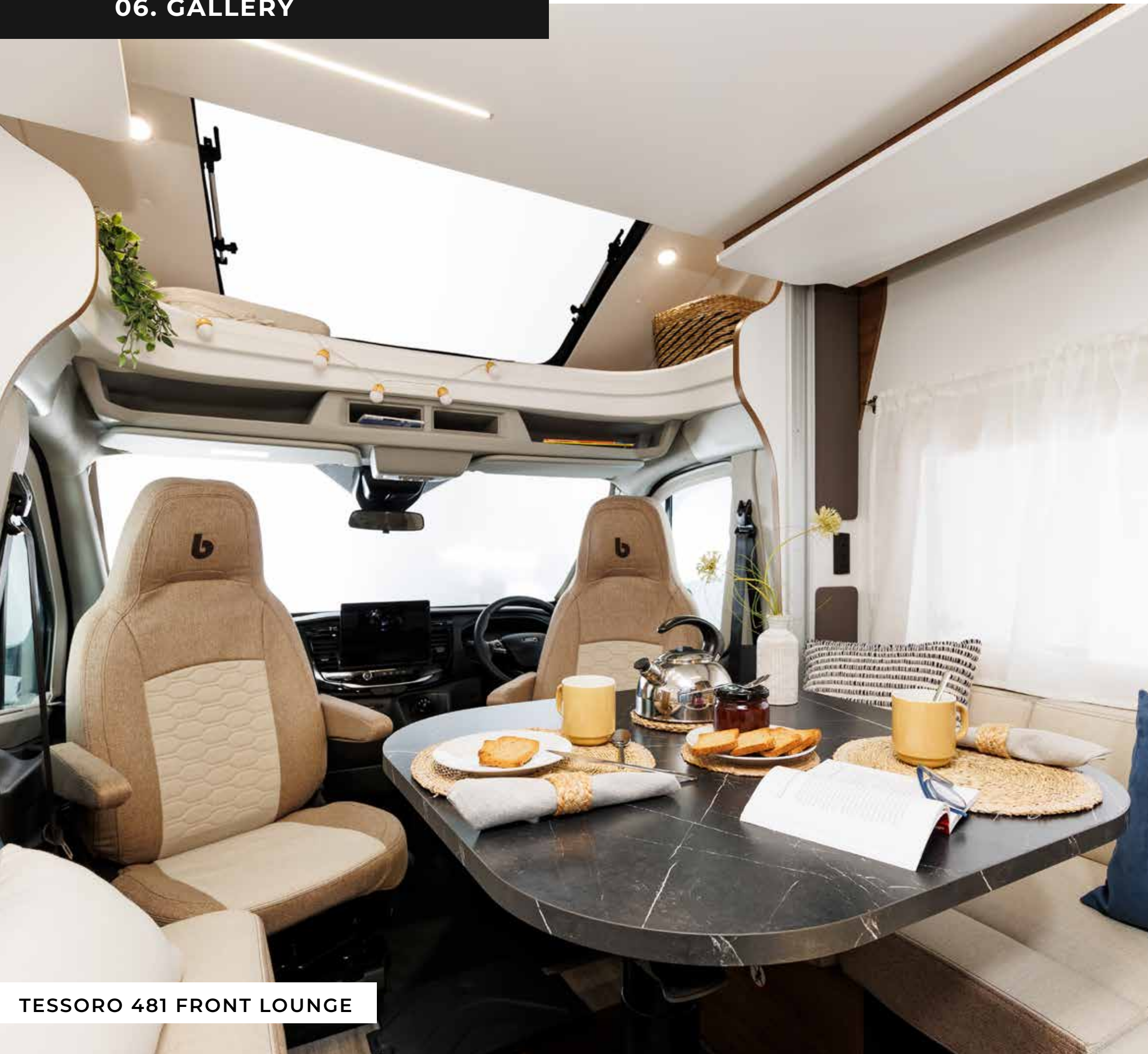

TESSORO 481 FRONT LOUNGE



TESSORO 840 BATHROOM



TESSORO 840 REAR BED

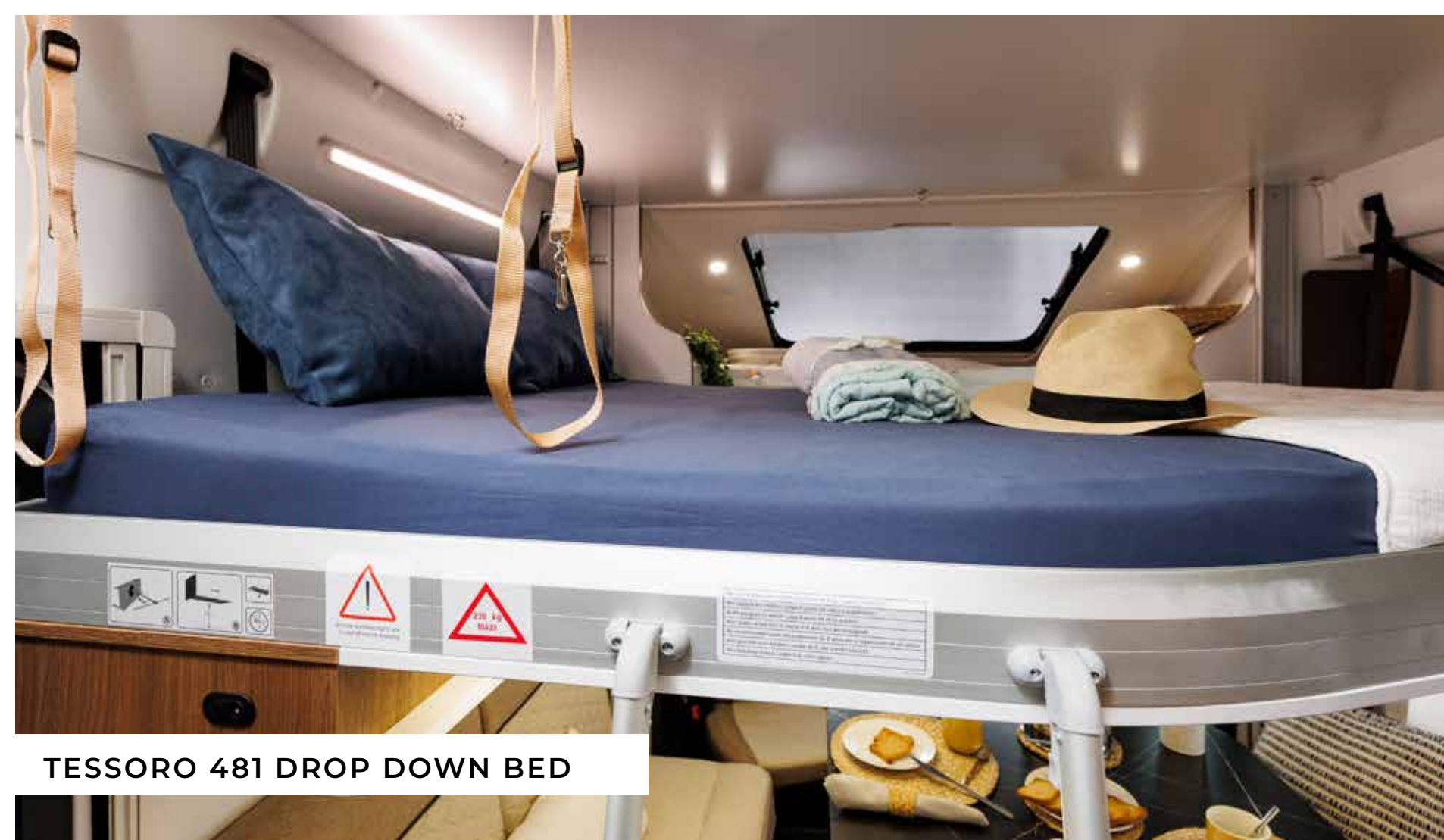

TESSORO 481 DROP DOWN BED



OVERVIEW

TESSORO RANGE

FEATURES

WEIGHTS & DIMENSIONS

TESSORO GALLERY

CONSTRUCTION

ABOUT BENIMAR

DEALER NETWORK



07. GALLERY



TESSORO 481 WARDROBE



TESSORO SKYVIEW

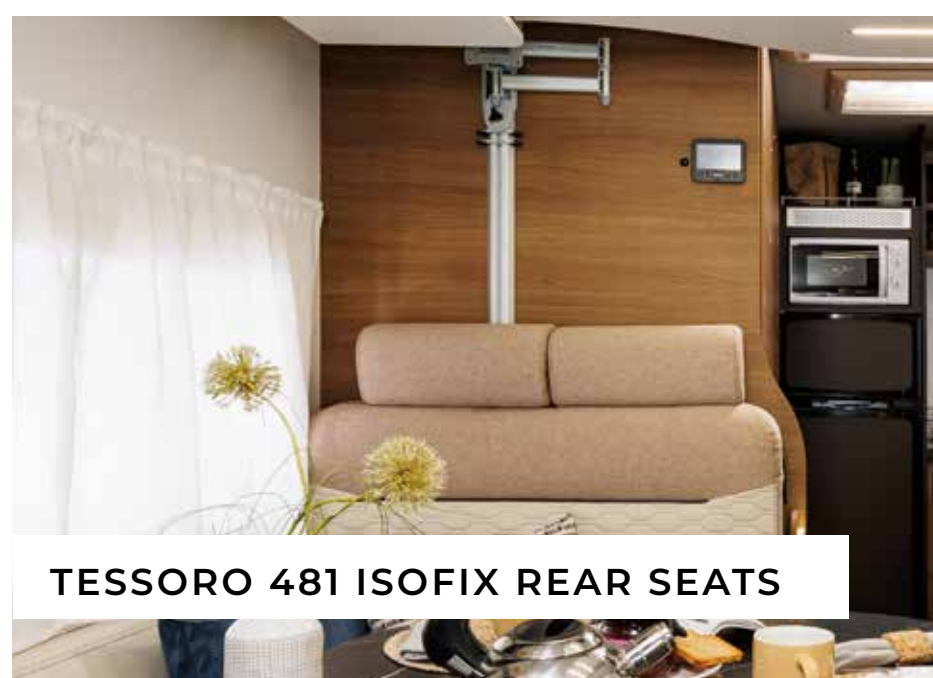

TESSORO 481 ISOFIX REAR SEATS



TESSORO FABRICS



TESSORO 840 KITCHEN



TESSORO 481 FRONT TO REAR



OVERVIEW

TESSORO RANGE

FEATURES

WEIGHTS & DIMENSIONS

TESSORO GALLERY

CONSTRUCTION

ABOUT BENIMAR

DEALER NETWORK



08. TESSORO CONSTRUCTION

The ISB (Isolation System Benimar) is a key feature in Benimar motorhomes, designed to provide superior insulation, comfort, and durability. This system helps maintain an optimal internal climate by reducing heat loss in colder months and keeping the interior cool during warmer weather. The materials and construction methods used in the ISB system also enhance the longevity of the motorhome, ensuring it stands up to the rigors of travel while providing a cozy living environment. Overall, it's a vital aspect of what makes Benimar motorhomes appealing to travelers seeking both comfort and reliability.

GRP and 99% Wood-Free Construction

The almost complete elimination of wood in the bodywork structure and using insulating and damp-proof materials not only enhances durability but also improves energy efficiency and comfort. This approach can significantly extend the lifespan of your motorhome, making it a wise investment for long-term adventures.

Insulation and Fuel Efficiency

The floor, roof and walls of your motorhome are constructed using XPS materials which have been proven to be extremely effective at insulating. Plus, its lightweight nature helps maintain the overall weight of the motorhome, which is essential for fuel efficiency and handling.



Grade III Fully Insulated NCC EN1645-1

Grade III classification for heating and thermal protection means Benimar motorhomes are built to withstand various weather conditions, ensuring comfort all year round. Whether you're exploring the great outdoors or parked in a cozy spot, you can enjoy a pleasant climate inside 365 days a year.

Ford Transit Euro 6E Engine

Easy to drive, safe and ready to assist you in every challenge, always adapting to your needs. Ford engines are effective in terms of fuel consumption and emissions, plus they are dynamic and environmentally friendly ensuring a comfortable driving experience with the latest driving features.



WARRANTY

When you choose a Benimar motorhome you have the reassurance of knowing your vehicle has been designed and constructed to give you years of enjoyable, worry free touring.

5 YEARS WATER INGRESS GUARANTEE

Benimar are confident in their construction process and every motorhome comes with a 5-year water ingress guarantee. This guarantee covers the damages that are due to an abnormal modification of the original bodyshell waterproofing.

2 YEARS HABITATION GUARANTEE

The guarantee covers the labour and parts supplied to replace or repair those found to be faulty completely free of charge for a period of 24 months from the date of registration of the vehicle.

3 YEARS FORD CHASSIS WARRANTY

All Benimar Tessoro motorhomes registered in the UK benefit from a 3 Year Ford Chassis Warranty. Peace of mind as standard with every Ford. Every new Ford passenger car and commercial vehicle comes with 12 months free Ford Assistance, a roadside rescue, repair, and recovery service that helps you at home or anywhere in Europe, seven days a week, 365 days a year.

For full warranty details please visit:

www.marquisleisure.co.uk/warranty



OVERVIEW

TESSORO
RANGE

FEATURES

WEIGHTS &
DIMENSIONS

TESSORO
GALLERY

CONSTRUCTION

ABOUT
BENIMAR

DEALER
NETWORK



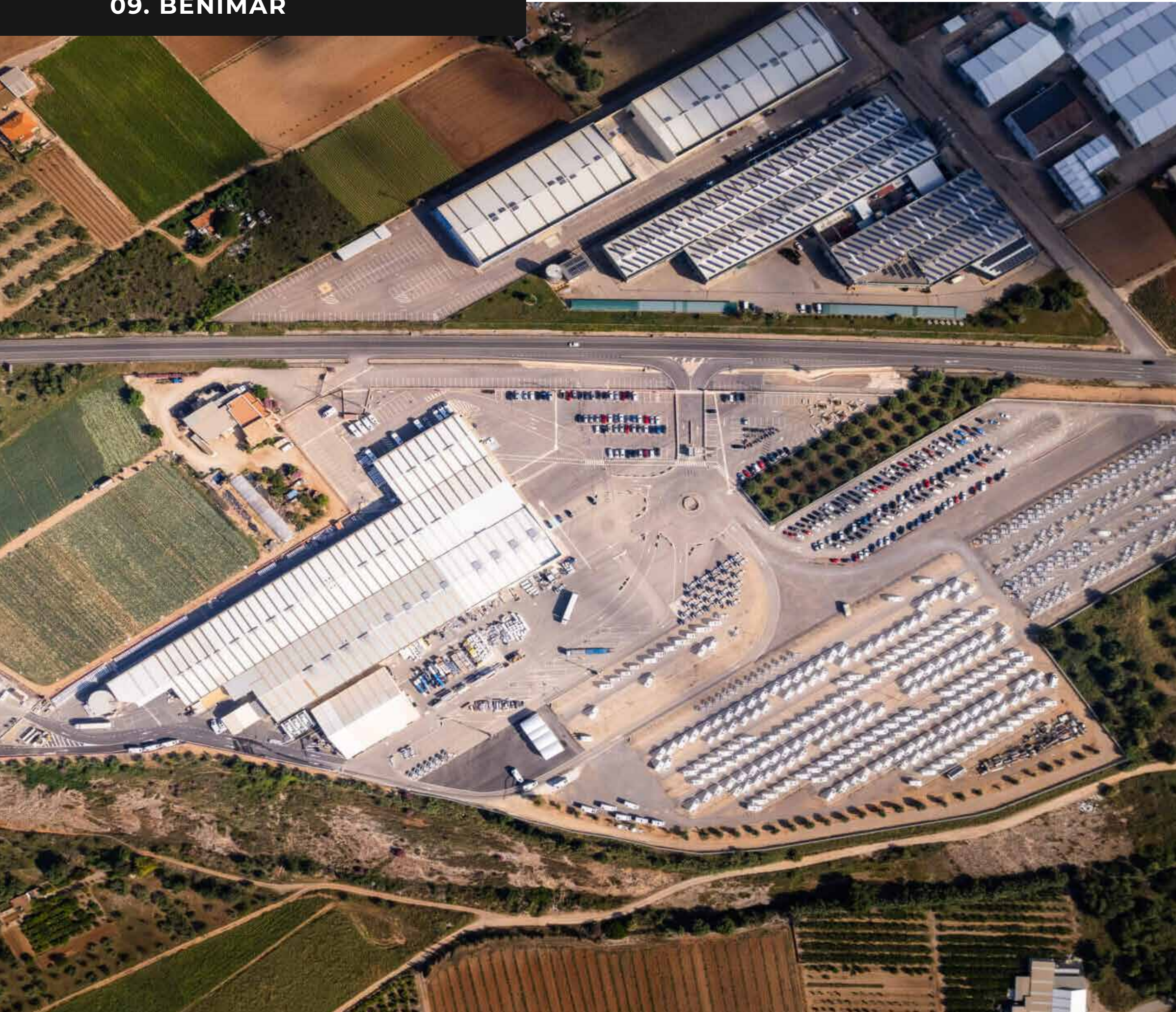

benimar

Benimar has been producing motorhomes for more than 50 years. Their reputation for quality and innovation has allowed them to expand significantly, reaching a global network of over 100 dealers from Europe to New Zealand. This growth reflects their commitment to providing versatile and reliable motorhomes that cater to a variety of leisure needs. Whether for family adventures or solo journeys, Benimar offers something for everyone.

Benimar motorhomes, part of the Trigano Group, are crafted in Peñíscola under the Mediterranean sun. The production facility spans 40,000 m² and utilizes high-tech machinery and innovative technologies to ensure quality and performance. This combination of advanced manufacturing and a beautiful setting reflects their commitment to creating reliable and comfortable motorhomes.

Marquis collaborates closely with Benimar to create an exclusive range of well-equipped motorhomes, all featuring NCC Approval and adhering to full UK specifications. This partnership ensures high-quality vehicles designed for comfort and performance on the road.

Benimar's commitment to reliability, quality, and strength is underscored by its ISO 9001 and ISO 14001 certifications. These certifications reflect a dedication to consistently meeting customer expectations while adhering to high standards in product quality and environmental management. This assurance enhances trust in their products and showcases their focus on continuous improvement and sustainability.



OVERVIEW

TESSORO RANGE

FEATURES

WEIGHTS & DIMENSIONS

TESSORO GALLERY

CONSTRUCTION

ABOUT BENIMAR

DEALER NETWORK



10. YOUR BENIMAR DEALER



AT YOUR LOCAL BENIMAR TESSORO DEALER



The UK's Largest Dealer Network

Marquis is the exclusive distributor for the Benimar Tessoro brand in England and work alongside our dealer partners in Scotland, Ireland and New Zealand. If you're looking for more information about our products, services, or anything regarding Benimar motorhomes, get in touch today with your local Benimar Tessoro dealer.

From the moment you order your new motorhome, through to delivery and beyond, our branches and dealer partners are dedicated to making your purchase and maintenance experience as hassle-free as possible.

MARQUIS LANCASHIRE
Riversway Leisure Village |
Chain Caul Road |
Docklands | Preston |
Lancashire | PR2 2PD

T: 01772 731 313

MARQUIS GLOUCESTERSHIRE
Mill Avon Holiday Park |
Gloucester Road |
Tewkesbury |
Gloucs | GL20 5SW

T: 01684 296 222

MARQUIS SOUTH YORKSHIRE
Rotherham Road |
Dinnington | Sheffield
South Yorkshire |
S25 3RF

T: 01909 495 900

MARQUIS DORSET
41-45 Old Wareham Rd |
Poole |
Dorset |
BH12 4QN

T: 01202 738 777

CALDER CAMPERS
Camps Industrial Estate |
East Calder | Livingston |
Scotland |
EH27 8DF

T: 01506 880 411

MARQUIS SUFFOLK
Farthing Road |
Sproughton |
Ipswich | Suffolk
IP1 5AP

T: 01473 747 675

MARQUIS SURREY/SUSSEX
Station Approach |
Gomshall |
Surrey |
GU5 9NX

T: 01483 203 335

MARQUIS NORTHANTS
The Causeway |
Great Billing |
Northampton |
Northants | NN3 9EX

T: 01604 402 888

MARQUIS BERKSHIRE
Oxford Road |
Chieveley |
Nr Newbury |
Berkshire | RG20 8RU

T: 01635 248 888

CAMPER NI
67 Moira Road |
Hillsborough |
Co. Down |
BT26 6DX

T: 028 9268 2220

DUBLIN MOTORHOMES
Unit T35 | Rowan Ave |
Stillorgan Business Park |
Sandyford | Dublin |
A94 K8Y6

T: 01-2939304

MARQUIS HAMPSHIRE
Winchester Road |
Lower Upham |
Nr Southampton |
Hampshire | SO32 1HA

T: 01489 860 666

MARQUIS EXETER
Sandygate |
Clyst Road |
Exeter |
Devon | EX2 7JL

T: 01392 446 250

MARQUIS DEVON (Plymouth)
Lee Mill |
Ivybridge |
Nr Plymouth |
Devon | PL21 9EG

T: 01752 892 977

MARQUIS DURHAM
Durham Road |
Birtley | Chester Le Street |
County Durham |
DH3 2QZ

T: 0191 492 2480

TRAILITE CHRISTCHURCH
10 Innovation Road |
Islington |
Christchurch |
8042

T: 03 222 2067

TRAILITE AUCKLAND
77 Paerata Road |
Pukekohe |
Auckland |
2120

T: 09 238 6869

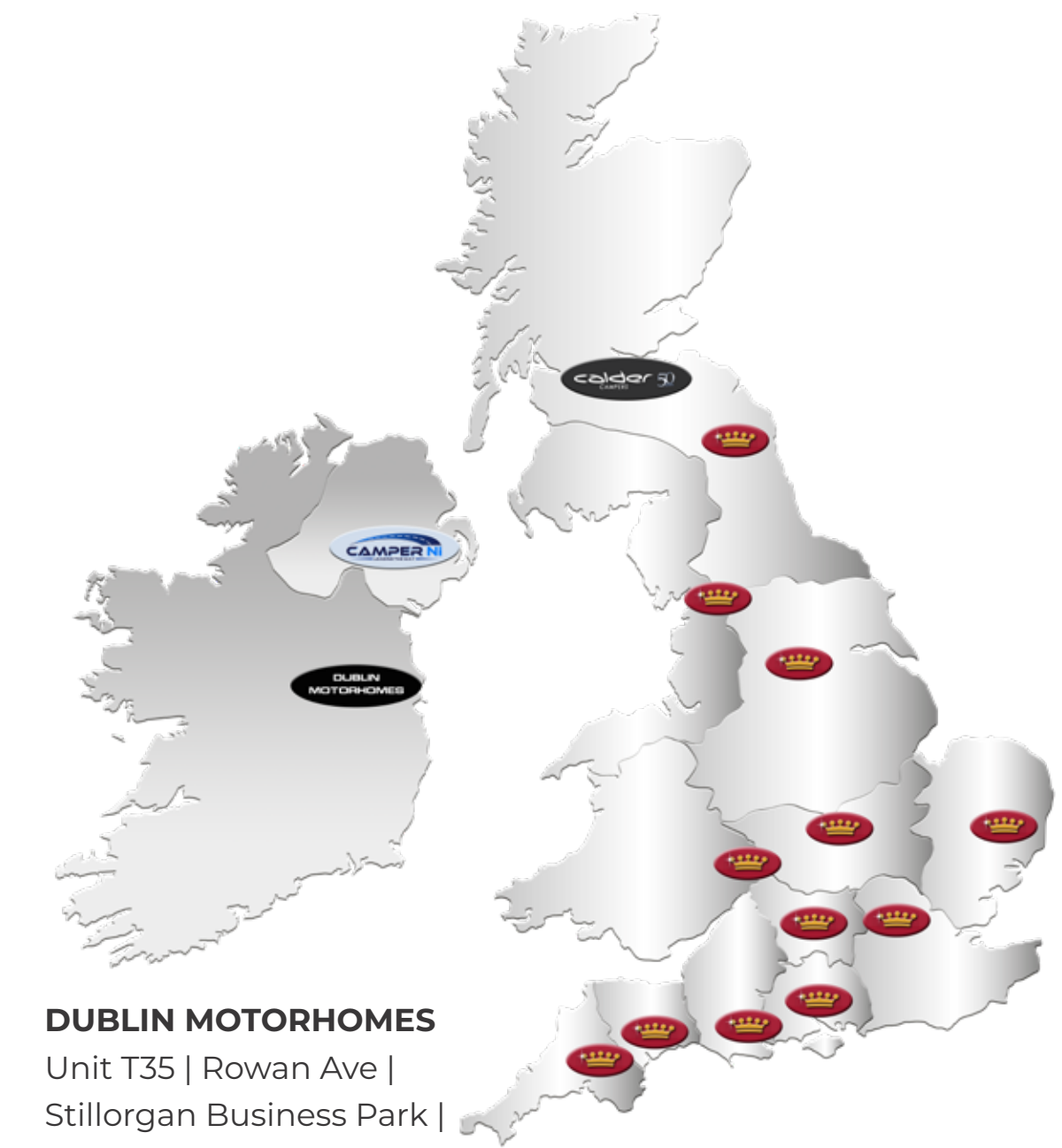

PLEASE CALL BEFORE TRAVELLING TO CHECK STOCK AT YOUR LOCAL DEALER.

 www.marquisleisure.co.uk

 www.camperni.com

 www.trailite.co.nz

 www.caldercampers.co.uk

 www.dublinmotorhomes.ie



OVERVIEW

TESSORO RANGE

FEATURES

WEIGHTS & DIMENSIONS

TESSORO GALLERY

CONSTRUCTION

ABOUT BENIMAR

DEALER NETWORK

