

# MILEO



CREATED FOR ADVENTURE



# 2025 SEASON PRICE LIST

PRICES AND SPECIFICATION EFFECTIVE 1<sup>ST</sup> OCTOBER 2024

## MILEO 243



4 BELTS 4 BERTHS ISOFIX

|                                |                 |             |
|--------------------------------|-----------------|-------------|
| OVERALL LENGTH                 | 6990mm   22'11" |             |
| OVERALL WIDTH (MIRRORS FOLDED) | 2300mm   7'6"   |             |
| OVERALL HEIGHT (EXC TV AERIAL) | 2890mm   9'5"   |             |
| MTPLM                          | 140BHP MANUAL   | 180BHP AUTO |
|                                | 3650kg          | 4400kg      |
| MAX USER PAYLOAD               | 501kg           | 1251kg      |

FIAT DUCATO 140BHP MANUAL ENGINE

**£79,995 OTR**

FIAT DUCATO 180BHP AUTOMATIC ENGINE

**£87,995 OTR**

## MILEO 286



4 BELTS 4 BERTHS ISOFIX

|                                |                |             |
|--------------------------------|----------------|-------------|
| OVERALL LENGTH                 | 6950mm   22'8" |             |
| OVERALL WIDTH (MIRRORS FOLDED) | 2300mm   7'6"  |             |
| OVERALL HEIGHT (EXC TV AERIAL) | 2890mm   9'5"  |             |
| MTPLM                          | 140BHP MANUAL  | 180BHP AUTO |
|                                | 3650kg         | 4400kg      |
| MAX USER PAYLOAD               | 519kg          | 1269kg      |

FIAT DUCATO 140BHP MANUAL ENGINE

**£79,995 OTR**

FIAT DUCATO 180BHP AUTOMATIC ENGINE

**£87,995 OTR**

## MILEO 282



4 BELTS 4 BERTHS ISOFIX

|                                |                |             |
|--------------------------------|----------------|-------------|
| OVERALL LENGTH                 | 7390mm   24'2" |             |
| OVERALL WIDTH (MIRRORS FOLDED) | 2300mm   7'6"  |             |
| OVERALL HEIGHT (EXC TV AERIAL) | 2890mm   9'5"  |             |
| MTPLM                          | 140BHP MANUAL  | 180BHP AUTO |
|                                | 3650kg         | 4400kg      |
| MAX USER PAYLOAD               | 434kg          | 1184kg      |

FIAT DUCATO 140BHP MANUAL ENGINE

**£81,995 OTR**

FIAT DUCATO 180BHP AUTOMATIC ENGINE

**£89,995 OTR**

## MILEO 294

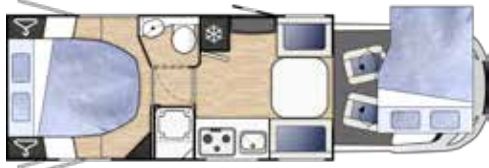

4 BELTS 4 BERTHS ISOFIX

|                                |                |             |
|--------------------------------|----------------|-------------|
| OVERALL LENGTH                 | 7390mm   24'2" |             |
| OVERALL WIDTH (MIRRORS FOLDED) | 2300mm   7'6"  |             |
| OVERALL HEIGHT (EXC TV AERIAL) | 2890mm   9'5"  |             |
| MTPLM                          | 140BHP MANUAL  | 180BHP AUTO |
|                                | 3650kg         | 4400kg      |
| MAX USER PAYLOAD               | 400kg          | 1146kg      |

FIAT DUCATO 140BHP MANUAL ENGINE

**£81,995 OTR**

FIAT DUCATO 180BHP AUTOMATIC ENGINE

**£89,995 OTR**

## OPTIONAL EXTRAS

PARADORE UPHOLSTERY IN LIEU OF STANDARD **£995**



FULL VEHICLE SPECIFICATION



360° VIRTUAL TOURS



BROCHURE DOWNLOAD

[WWW.BENIMARMILEO.CO.UK](http://WWW.BENIMARMILEO.CO.UK)



SCAN HERE TO VIEW FULL 2025 SPECIFICATION & NATIONWIDE STOCK.



**IMPORTANT INFORMATION** The contents of this publication are as accurate as possible at the time of going to press (February 2025), but this information should not be regarded as an infallible guide to current specifications, nor does it constitute an offer for the sale of any particular vehicle. Prices effective 1<sup>st</sup> October 2024. The base price is for the vehicle with its standard specification. The On the Road (OTR) price includes the cost of Number Plates, all delivery charges, First Year VED (Road Tax) and 1<sup>st</sup> Registration Fee (as set by H.M Government) at point of registration. VAT inclusive at 20%. Marquis Motorhomes & Caravans is a registered trademark of The Auto-Sleepers Group Ltd. This price list supersedes all others.